



SHEET 1 OF 2
1:250@A1;1:500@A3

SHEET 2 OF 2
1:250@A1;1:500@A3

NOTE: REFER TO DRAWING NO. MAY-MDC-HRW-LC03-DR-C-0302, FOR PORTERSTOWN CROSS SECTIONS

REV	DATE	DESCRIPTION	PRODUCED BY	REVIEWED BY	APPROVED BY
V 02	October 2024	UPDATED RAILWAY ORDER	JMC	TL	MK
V 01	April 2022	PHASE 3 - PRELIMINARY DESIGN	JMC	TL	MK

© Irish Rail (2021). This drawing is confidential and the copyright in it is owned by Irish Rail. This drawing must not be either loaned, copied or otherwise reproduced in whole or in part or used for any purpose without the prior permission of Irish Rail.
 © Ordnance Survey Ireland and Government of Ireland. All O.S. data used for plans are printed under "Copyright Ordnance Survey Ireland".
 Survey No. 6039721 (OSi Aerial Data or OSi Lidar Data) & Survey No. 2021058_LMA_110 (OSi Vector Data).
 All elevations are in metres and relate to OSi Geoid Model1 (OSGM02) Mean-Higher as defined by existing Project Control.
 All Coordinates are in Irish Transverse Mercator Grid (ITM) as defined by OSi active GPS station Tallaght College (TLG0).

Client

Tionscatal Éireann
Project Ireland
2040

NTA
Údairse Náisiúnta Iomparáil
National Transport Authority

Iarnród Éireann
Irish Rail

Consultant

IDOM

G3

PROD
ROUGHAN & O'DONOVAN

Project

DART+
West

Drawing Title

ROADWORKS DESIGN - LC03: PORTERSTOWN
GENERAL ARRANGEMENT
OVERALL LAYOUT

Scale:
1:500 @ A1 1:1,000 @ A3

Drawing Number | Project | Originator | Discipline | Location | Type | Role | Number | Phase
MAY | MDC | HRW | LC03 | DR | C | 0100 | C

Date: October 2024 Job No: P/101086 Status: F1 - Approved & Accepted Rev: V01 Sheet: 01 of 01



NOTES

- ALL DIMENSIONS ARE IN METRES UNLESS NOTED OTHERWISE.
- ALL LEVELS ARE IN METRES ABOVE NATIONAL ORDNANCE DATUM. ALL LEVELS ARE IN METRES ABOVE NATIONAL ORDNANCE DATUM.

LEGEND

- CARRIAGEWAY
- FOOTWAY
- VERGE
- EMBANKMENT

V 02	October 2024	UPDATED RAILWAY ORDER	JMC	TL	MK
V 01	April 2022	PHASE 3 - PRELIMINARY DESIGN	JMC	TL	MK
REV	DATE	DESCRIPTION	PRODUCED BY	REVIEWED BY	APPROVED BY

© Irish Rail (2021). This drawing is confidential and the copyright in it is owned by Irish Rail. This drawing must not be either loaned, copied or otherwise reproduced in whole or in part or used for any purpose without the prior permission of Irish Rail.
 © Ordnance Survey Ireland and Government of Ireland. All O.S. data used for plans are printed under "Copyright Ordnance Survey Ireland".
 Survey No. 6039721 (OSi Aerial Data or OSi Lidar Data) & Survey No. 20211058_LMA_110 (OSi Vector Data).
 All elevations are in metres and relate to OSi Geoid Model1 (OSGM02) Mean-Higher as defined by existing Project Control.
 All Coordinates are in Irish Transverse Mercator Grid (ITM) as defined by OSi active GPS station Tallaght College (TLG).

Client

Tionscadal Éireann
Project Ireland
2040

NTA
Údair Náisiúnta Iompar
National Transport Authority

Iarnród Éireann
Irish Rail

Consultant

IDOM

G3

IRIOD
ROGHIAN & O'DONOVAN

Project

DART+
West

Drawing Title

ROADWORKS DESIGN - LC03: PORTERSTOWN
GENERAL ARRANGEMENT
SHEET 1 OF 2

Scale:
1:250 @ A1 1:500 @ A3

Drawing Number | Project | Originator | Discipline | Location | Type | Role | Number | Phase
MAY MDC HRW LC03 DR C 0101 C

Date: October 2024 Job No: P/101086 Status: F1 - Approved & Accepted Rev: V01 Sheet: 01 of 02



NOTES

- ALL DIMENSIONS ARE IN METRES UNLESS NOTED OTHERWISE.
- ALL LEVELS ARE IN METRES ABOVE NATIONAL ORDNANCE DATUM. ALL LEVELS ARE IN METRES ABOVE NATIONAL ORDNANCE DATUM.

LEGEND

- CARRIAGEWAY
- FOOTWAY
- VERGE
- EMBANKMENT

V 02	October 2024	UPDATED RAILWAY ORDER	JMC	TL	MK
V 01	April 2022	PHASE 3 - PRELIMINARY DESIGN	JMC	TL	MK
REV.	DATE	DESCRIPTION	PRODUCED BY	REVIEWED BY	APPROVED BY

© Irish Rail (2021). This drawing is confidential and the copyright in it is owned by Irish Rail. This drawing must not be either loaned, copied or otherwise reproduced in whole or in part or used for any purpose without the prior permission of Irish Rail.
 © Ordnance Survey Ireland and Government of Ireland. All O.S. data used for plans are printed under "Copyright Ordnance Survey Ireland"
 Survey No. 6039721 (OSi Aerial Data or OSi Lidar Data) & Survey No. 2021058_LNMA_110 (OSi Vector Data).
 All elevations are in metres and relate to OSi Geoid Model1 (OSGM02) Mean-Higher as defined by existing Project Control.
 All Coordinates are in Irish Transverse Mercator Grid (ITM) as defined by OSi active GPS station Tallaght College (TLTG).

Client

Consultant

Project

Drawing Title

ROADWORKS DESIGN - LC03: PORTERSTOWN
GENERAL ARRANGEMENT
SHEET 2 OF 2

Scale:
1:250 @ A1 1:500 @ A3

Drawing Number	Project	Originator	Discipline	Location	Type	Role	Number	Phase
MAY	MDC	HRW	LC03	DR	C	0102	C	C

Date:	Job No:	Status:	Rev:	Sheet:
October 2024	P/101086	F1 - Approved & Accepted	V01	02 of 02

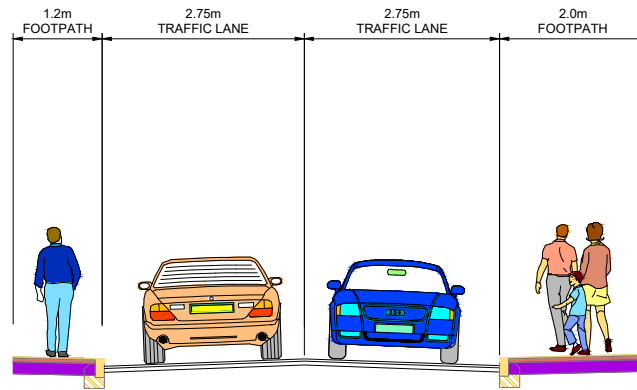

TYPICAL CROSS SECTION A-A
PORTERSTOWN STATION
LOCATED ON GA SHEET 01
DRAWING REF: MAY-MDC-HRW-LC03-DR-C-0100

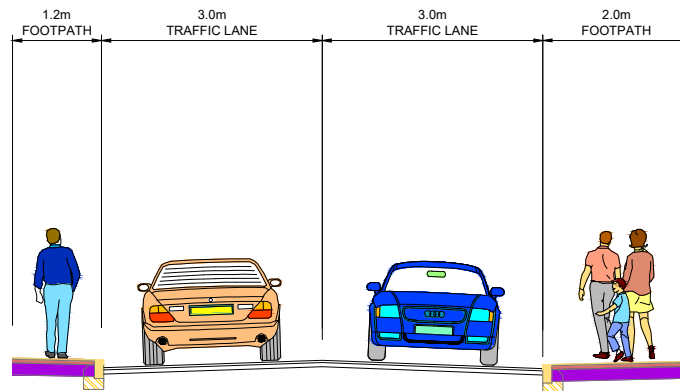

TYPICAL CROSS SECTION B-B
PORTERSTOWN STATION
LOCATED ON GA SHEET 01
DRAWING REF: MAY-MDC-HRW-LC03-DR-C-0100

NOTES:

1. FOR SECTION LOCATIONS SEE DRAWING: MAY-MDC-HRW-LC03-DR-C-0100
2. THE BOUNDARY TREATMENT SHOWN IS INDICATIVE ONLY.
3. THE PROPOSED PAVEMENT CONSTRUCTION IS INDICATIVE ONLY.

REV.	DATE	DESCRIPTION	KH	TL	MK
V 01	April 2022	PLANNING ISSUE			

© Irish Rail (2021). This drawing is confidential and the copyright in it is owned by Irish Rail. This drawing must not be either loaned, copied or otherwise reproduced in whole or in part or used for any purpose without the prior permission of Irish Rail.
© Ordnance Survey Ireland and Government of Ireland. All O.S. data used for plans are printed under "Copyright Ordnance Survey Ireland"
Survey No: 8038721 (OSi Aerial Data or OSi Lidar Data) & Survey No: 202108L_MMA_188 (OSi Vector Data)
All elevations are in metres and relate to OSi Geoid Model (OSGM02) Malin Head as defined by existing Project Control.
All Co-ordinates are in Irish Transverse Mercator Grid (ITM) as defined by OSi active GPS station Tallaght College (TLTG).

Client

Consultant

Project

Drawing Title

ROADWORKS DESIGN - LC03: PORTERSTOWN
PORTERSTOWN ROAD JUNCTION - CROSS SECTIONS
SHEET 01 of 01

Scale:	1:50 @ A1	1:100 @ A3						
Drawing Number	Project	Originator	Discipline	Location	Type	Role	Number	Phase
MAY	MDC	HRW	LC03	DR	C	0115	D	
Date:	Job No:	Status:	Rev:	Sheet:				
April 2022	P/101086	F1 - Approved & Accepted	V 01	01 of 01				

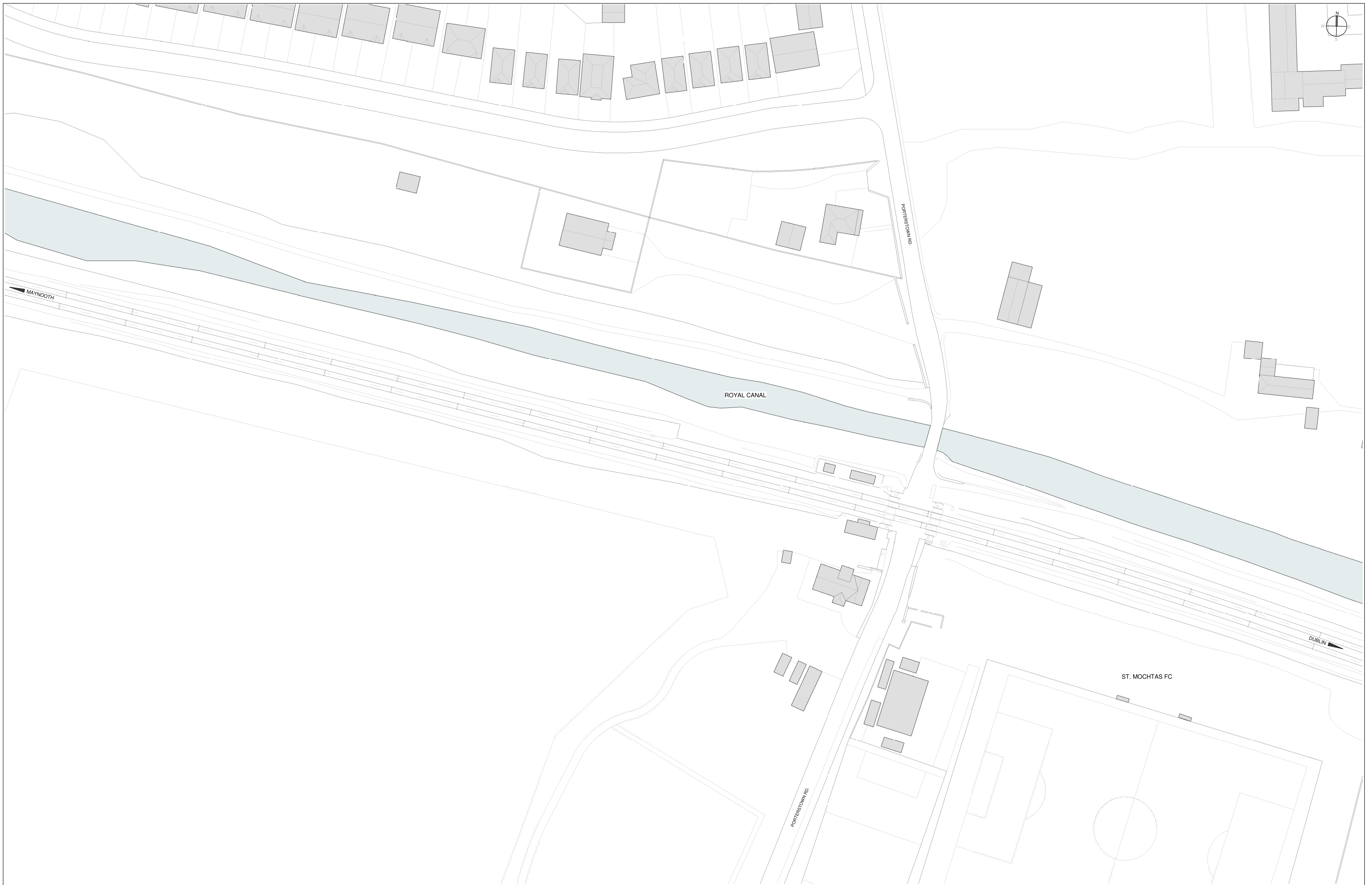

REV.	DATE	DESCRIPTION	PRODUCED BY	REVIEWED BY	APPROVED BY
V01	August 2023	Proposed Developments following Railway Order Submissions	GDV	JDR	CCH

© Irish Rail (2023). This drawing is confidential and the copyright in it is owned by Irish Rail. This drawing must not be either loaned, copied or otherwise reproduced in whole or in part or used for any purpose without the prior permission of Irish Rail.
 © Ordnance Survey Ireland and Government of Ireland. All O.S. data used for plans are printed under "Copyright Ordnance Survey Ireland".
 Survey No. 6039720 (OSI Aerial Data or OSI Lidar Data) & Survey No. 2020 OSI JMA_160 (OSI Vector Data).
 All elevations are in metres and relate to OSI Geoid Model (OSGM02) Mean Head as defined by existing Project Control.
 All Co-ordinates are in Irish Transverse Mercator Grid (ITM) as defined by OSI active GPS station Tallaght College (TLTG).

Client

Consultant

Project

Drawing Title

LEVEL CROSSING DESIGN
PORTERSTOWN PEDESTRIAN CROSSING
STATION LOCATION. EXISTING

Scale: 1:500 @ A1

Drawing Number	Project	Originator	Discipline	Location	Type	Role	Number	Phase
	MAY	MDC	ARC	LC03	DR	A	0001	D

Date	Job No.	Status	Rev.	Sheet
AUGUST 2023	P/101086	S3 - For Review & Comment	V01	1 of 2

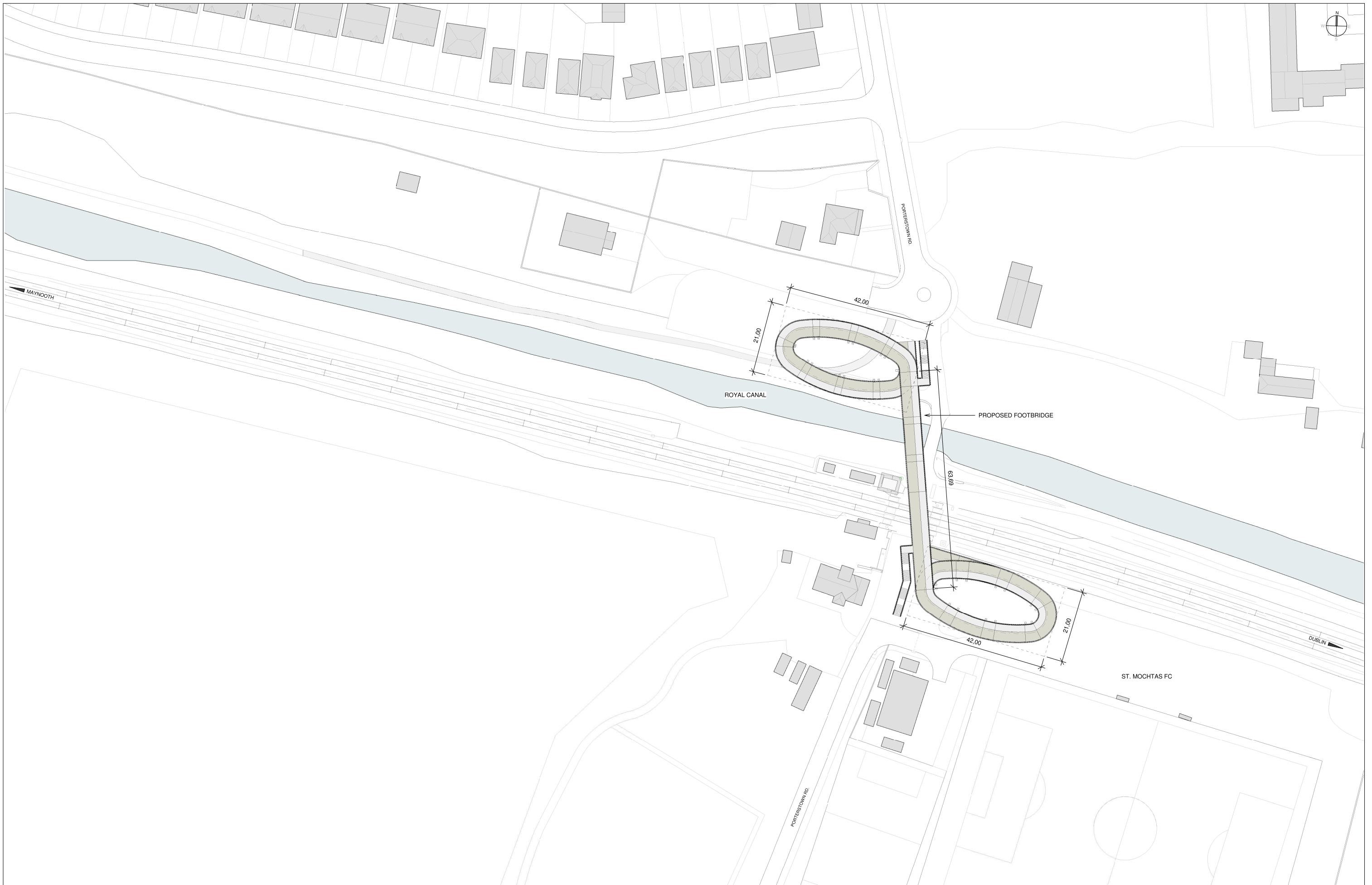

REV.	DATE	DESCRIPTION	PRODUCED BY	REVIEWED BY	APPROVED BY
V01	August 2023	Proposed Developments following Railway Order Submissions	GDV	JDR	CCH

© Irish Rail (2023). This drawing is confidential and the copyright in it is owned by Irish Rail. This drawing must not be either loaned, copied or otherwise reproduced in whole or in part or used for any purpose without the prior permission of Irish Rail.
 © Ordnance Survey Ireland and Government of Ireland. All O.S. data used for plans are printed under "Copyright Ordnance Survey Ireland".
 Survey No. 6039720 (OSI Aerial Data or OSI Lidar Data) & Survey No. 2020/OSI/JMA_160 (OSI Vector Data).
 All elevations are in metres and relate to OSI Geoid Model (OSGM02) Mean Head as defined by existing Project Control.
 All Co-ordinates are in Irish Transverse Mercator Grid (ITM) as defined by OSI active GPS station Tallaght College (TLTG).

Client

Consultant

Project

Drawing Title

**LEVEL CROSSING DESIGN
PORTERSTOWN PEDESTRIAN CROSSING
STATION LOCATION, PROPOSED**

Scale: 1:500 @ A1

Drawing Number	Project	Originator	Discipline	Location	Type	Role	Number	Phase
MAY	MDC	ARC	LC03	DR	A	0001	D	

Date	Job No.	Status	Rev.	Sheet
AUGUST 2023	P/101086	S3 - For Review & Comment	V01	2 of 2

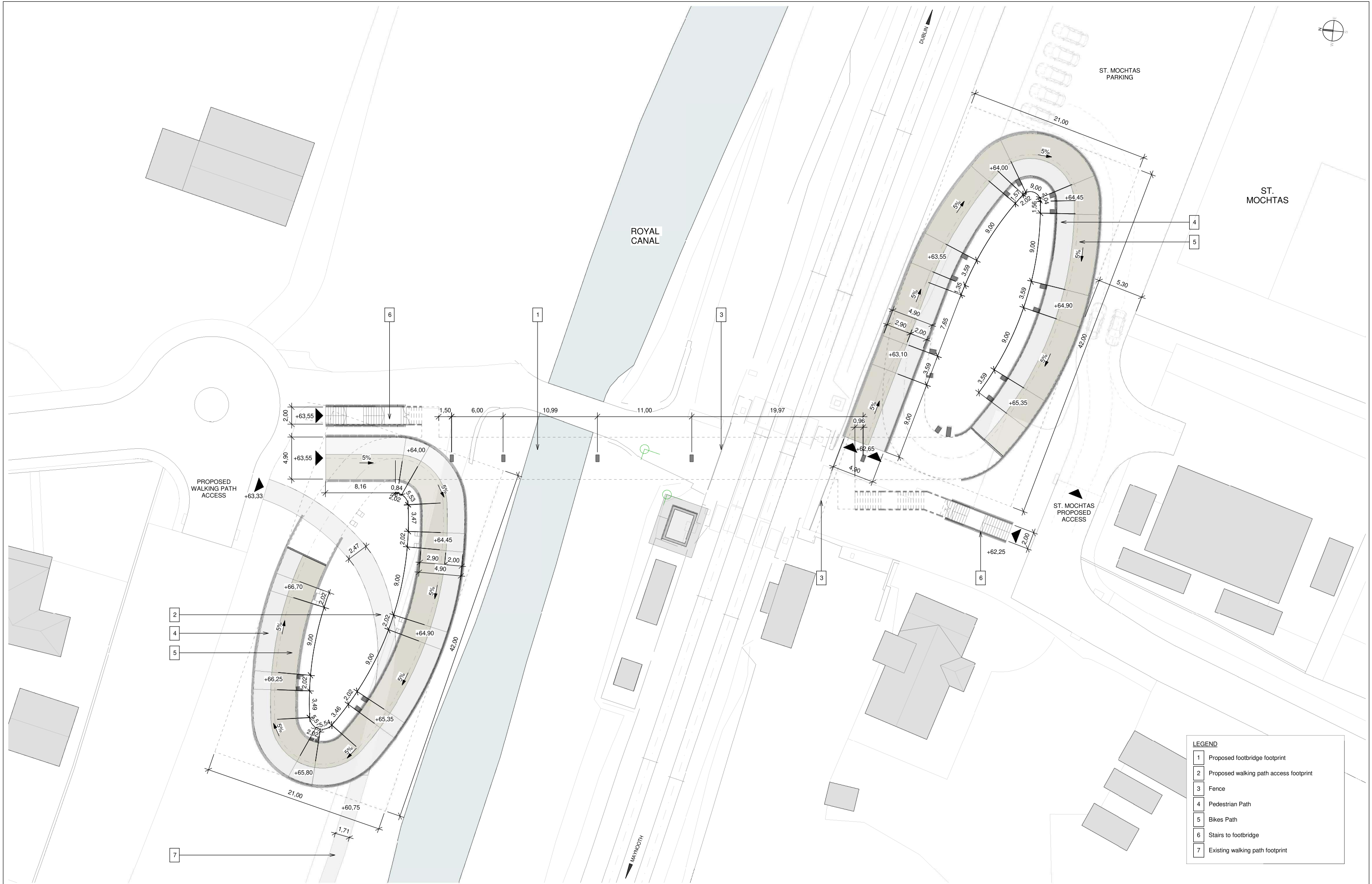

LEGEND	
1	Proposed footbridge footprint
2	Proposed walking path access footprint
3	Fence
4	Pedestrian Path
5	Bikes Path
6	Stairs to footbridge
7	Existing walking path footprint

REV.	DATE	Description	PRODUCED BY	REVIEWED BY	APPROVED BY
V01	AUGUST 2023	Proposed Developments following Railway Order Submissions	GDV	JDR	CCH

© Irish Rail (2023). This drawing is confidential and the copyright in it is owned by Irish Rail. This drawing must not be either loaned, copied or otherwise reproduced in whole or in part or used for any purpose without the prior permission of Irish Rail.
 © Ordnance Survey Ireland and Government of Ireland. All O.S. data used for plans are printed under "Copyright Ordnance Survey Ireland".
 Survey No. 6039720 (OSI Aerial Data or OSI Lidar Data) & Survey No. 2020/OSI/JMA_160 (OSI Vector Data).
 All elevations are in metres and relate to OSI Geoid Model (OSGM02) Mean Head as defined by existing Project Control.
 All Co-ordinates are in Irish Transverse Mercator Grid (ITM) as defined by OSI active GPS station Tallaght College (TLTG).

Client

Tionscatal Éireann
Project Ireland
2040

NTA
Uachtarán Náisiúnaí Iompartha
National Transport Authority

Iarnród Éireann
Irish Rail

Consultant

IDOM

C3

FJROD
EUGHRAN & O'DONOVAN

Project

DART+
West

Drawing Title

LEVEL CROSSING DESIGN
PORTERSTOWN PEDESTRIAN CROSSING
STREET LEVEL PLAN

Scale:

1:200 @ A1

Drawing Number | Project | Originator | Discipline | Location | Type | Role | Number | Phase

MAY | MDC | ARC | LC03 | DR | A | 0002 | D

Date: AUGUST 2023 | Job No: P/101086 | Status: S3 - For Review & Comment | Rev: V01 | Sheet: 1 of 2

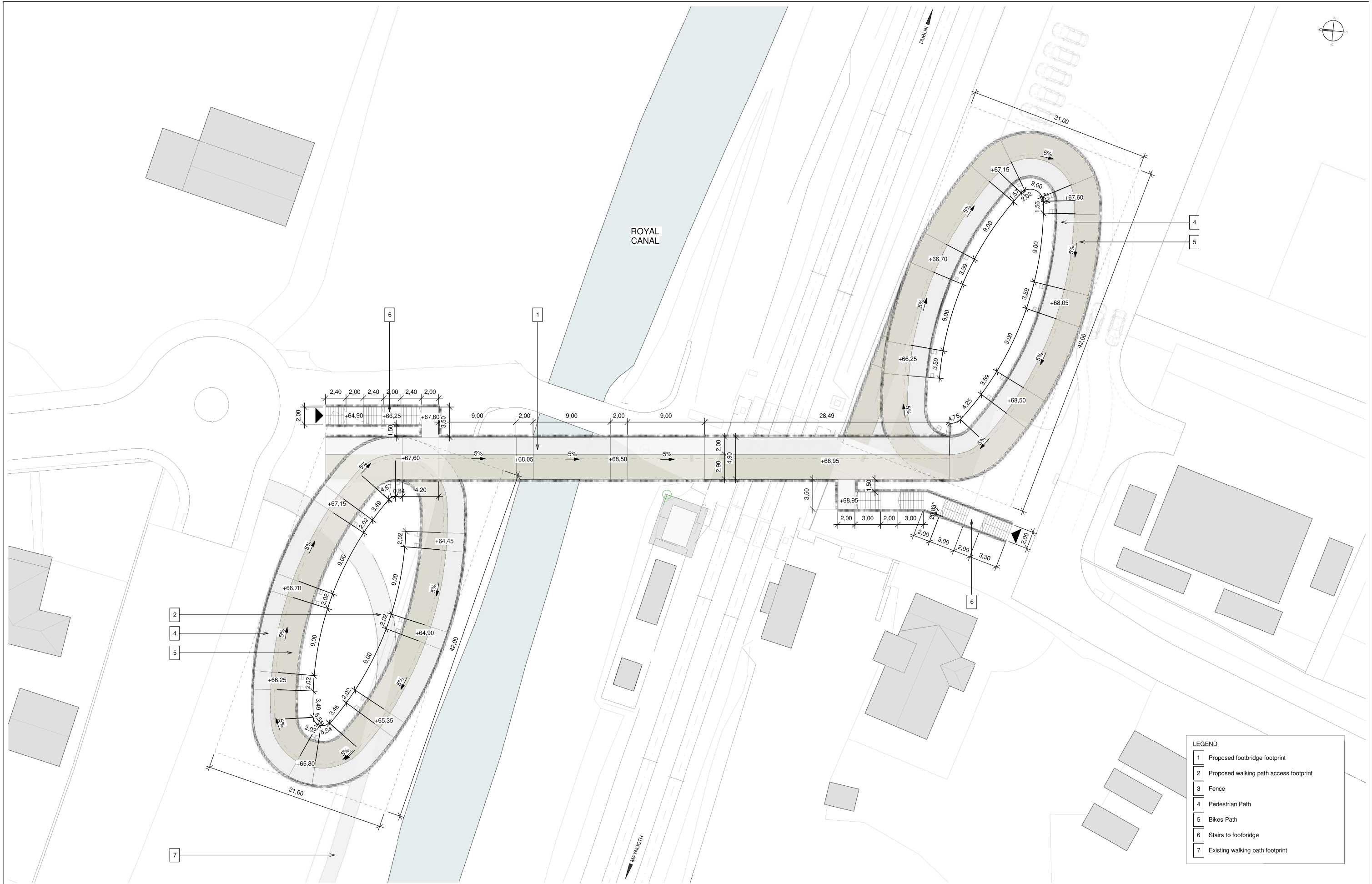

LEGEND

1	Proposed footbridge footprint
2	Proposed walking path access footprint
3	Fence
4	Pedestrian Path
5	Bikes Path
6	Stairs to footbridge
7	Existing walking path footprint

REV.	DATE	DESCRIPTION	PRODUCED BY	REVIEWED BY	APPROVED BY
V01	AUGUST 2023	Proposed Developments following Railway Order Submissions	GDV	JDR	CCH

© Irish Rail (2023). This drawing is confidential and the copyright in it is owned by Irish Rail. This drawing must not be either loaned, copied or otherwise reproduced in whole or in part or used for any purpose without the prior permission of Irish Rail.
 © Ordnance Survey Ireland and Government of Ireland. All O.S. data used for plans are printed under "Copyright Ordnance Survey Ireland".
 Survey No. 6039720 (OSI Aerial Data or OSI Lidar Data) & Survey No. 2020/OSI/JMA_160 (OSI Vector Data).
 All elevations are in metres and relate to OSI Geoid Model (OSGM02) Mean Head as defined by existing Project Control.
 All Co-ordinates are in Irish Transverse Mercator Grid (ITM) as defined by OSI active GPS station Tallaght College (TLG).

Client

Tionscatal Éireann
Project Ireland
2040

NTA
Udarás Náisiúnta Iompair
National Transport Authority

Iarnród Éireann
Irish Rail

Consultant

IDOM

C3

PROJOD
ROGHAN & O'DONOVAN

Project

DART+
West

Drawing Title

LEVEL CROSSING DESIGN
PORTERSTOWN PEDESTRIAN CROSSING
FOOTBRIDGE LEVEL PLAN

Scale:
1:200 @ A1

Drawing Number	Project	Originator	Discipline	Location	Type	Role	Number	Phase
	MAY	MDC	ARC	LC03	DR	A	0002	D

Date:	Job No.:	Status:	Rev.:
AUGUST 2023	P/101086	S3 - For Review & Comment	V01

Sheet: 2 of 2

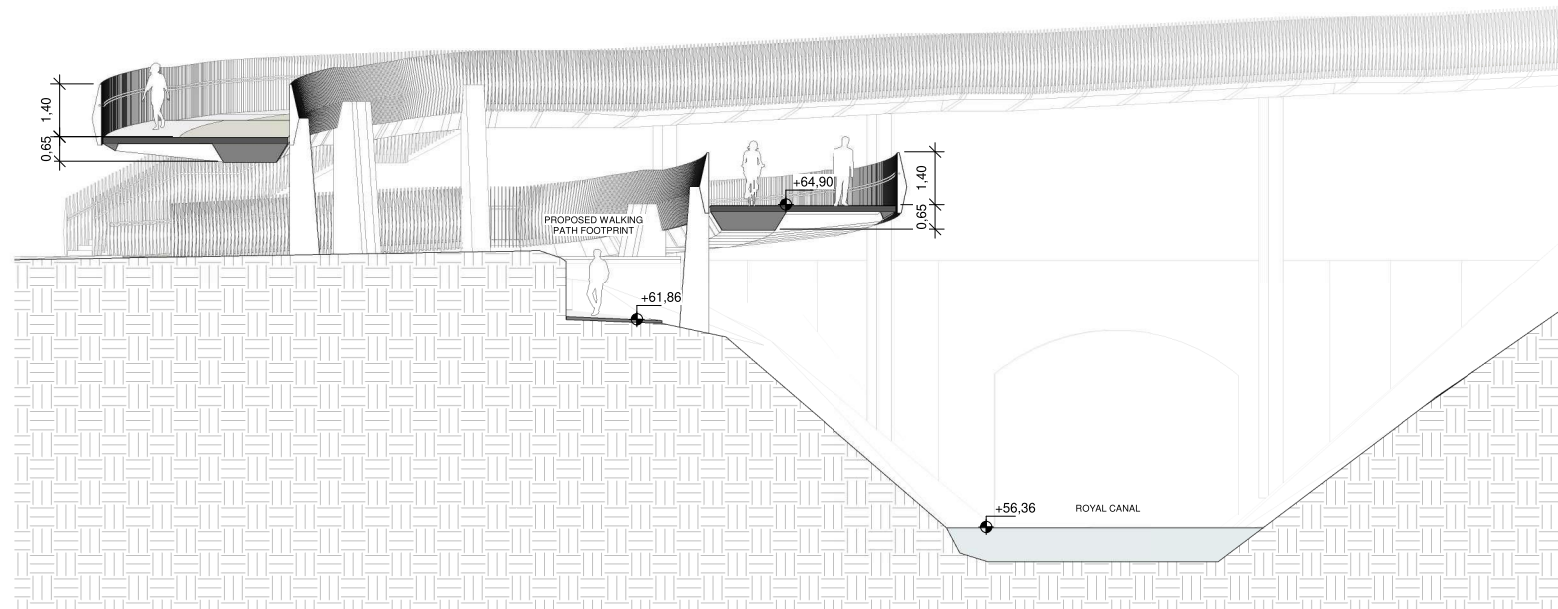

1 | Cross Section 01_North Oval
Scale 1:100

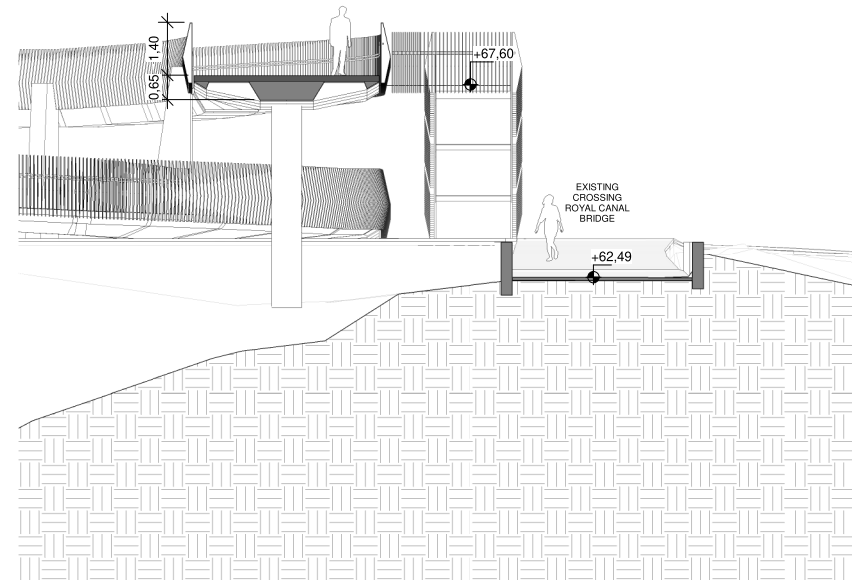

3 | Cross Section 03_Bridge
Scale 1:100

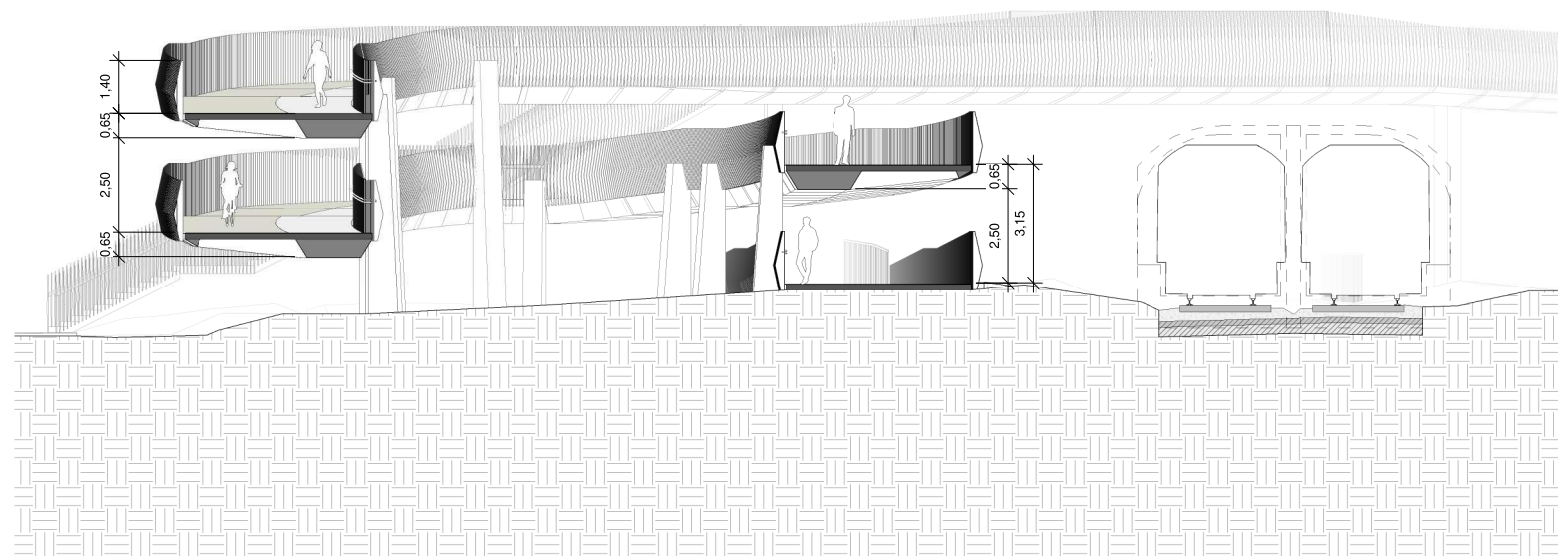

2 | Cross Section 02_South Oval
Scale 1:100

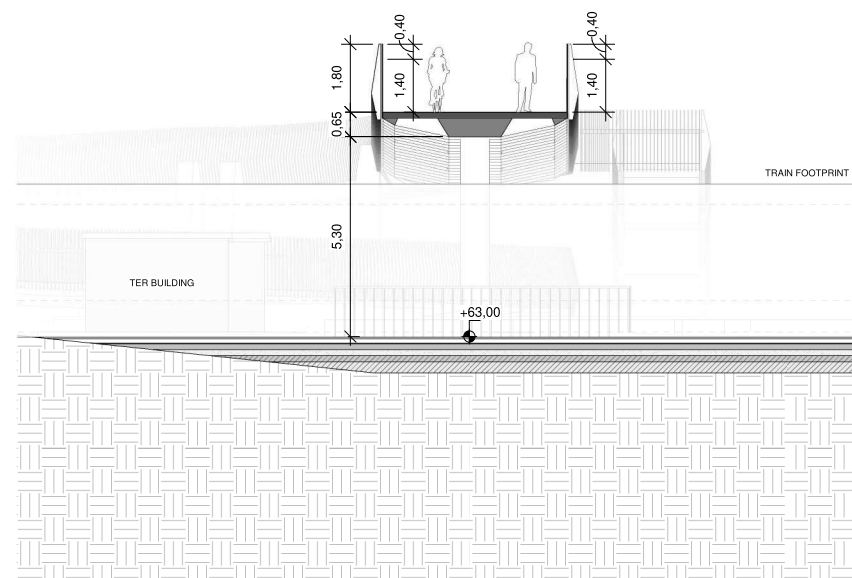

4 | Cross Section 04_Track
Scale 1:100

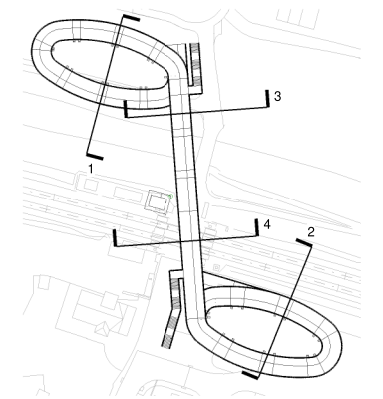

- NOTES**
- The retaining system will be defined with the input of the Geotechnical Report.
 - The foundation (deep or shallow) will be defined with the input of the Geotechnical Report and the retaining system.
 - Minimum track clearance under the bridge: 5.30 m.
 - Minimum clearance between existing walking path and proposed footbridge: 2.50 m
 - Additional protection will be provided when bridge crosses de track:
- 1.40 m height solid railing + 0.40 m height IP2X mesh
- no handrails

REV.	DATE	Description	PRODUCED BY	REVIEWED BY	APPROVED BY
V01	August 2023	Proposed Developments following Railway Order Submissions	GDV	JDR	CCH

© Irish Rail (2023). This drawing is confidential and the copyright in it is owned by Irish Rail. This drawing must not be either loaned, copied or otherwise reproduced in whole or in part or used for any purpose without the prior permission of Irish Rail.
© Ordnance Survey Ireland and Government of Ireland. All O.S. data used for plans are printed under "Copyright Ordnance Survey Ireland".
Survey No. 6039720 (OSI Aerial Data or OSI Lidar Data) & Survey No. 2020 OSI JMA_160 (OSI Vector Data).
All elevations are in metres and relate to OSI Geoid Model (OSGM02) Mean Head as defined by existing Project Control.
All Co-ordinates are in Irish Transverse Mercator Grid (ITM) as defined by OSI active GPS station Tallaght College (TLG).

Client

Tionscald Éireann
Project Ireland
2040

NTA
Údarás Náisiúnta Iompartha
National Transport Authority

Iarnród Éireann
Irish Rail

Consultant

IDOM

C3

PROJOD
ROUHAN & O'DONOVAN

Project

DART+
West

Drawing Title

LEVEL CROSSING DESIGN
PORTERSTOWN PEDESTRIAN CROSSING
CROSS SECTIONS

Scale:
1:100 @ A1

Drawing Number | Project | Originator | Discipline | Location | Type | Role | Number | Phase
MAY | MDC | ARC | LC03 | DR | A | 0003 | D

Date: AUGUST 2023 | Job No: P/101086 | Status: S3 - For Review & Comment | Rev: V01 | Sheet: 1 of 1

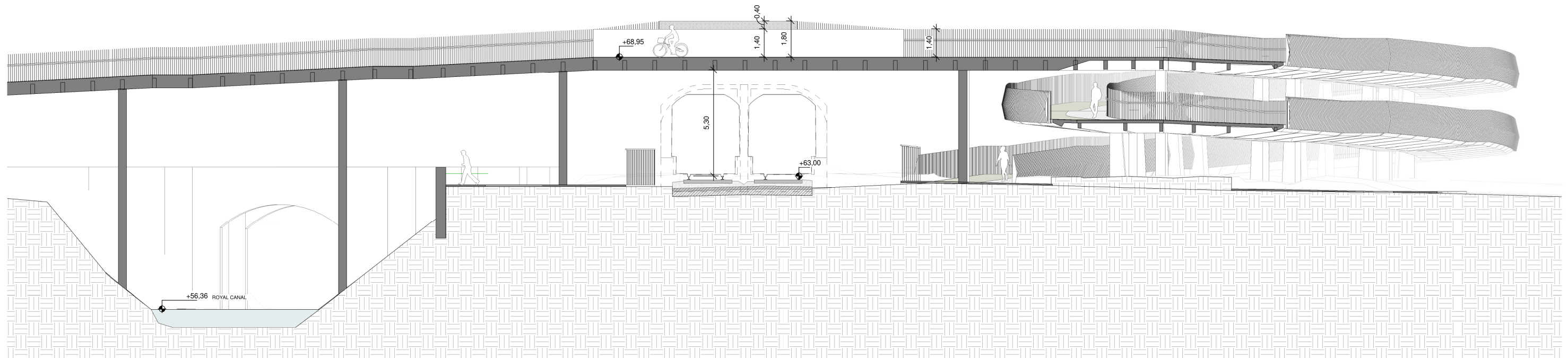
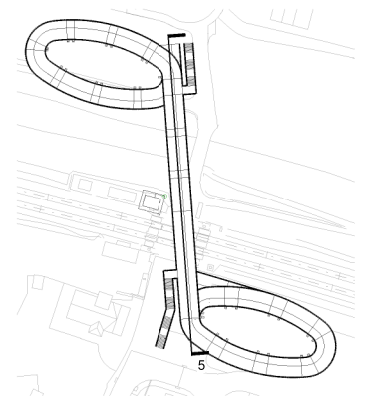

5 | Longitudinal Section
Scale 1:100

- NOTES**
- 1 The retaining system will be defined with the input of the Geotechnical Report.
 - 2 The foundation (deep or shallow) will be defined with the input of the Geotechnical Report and the retaining system.
 - 3 Minimum track clearance under the bridge: 5.30 m.
 - 4 Minimum clearance between existing walking path and proposed footbridge: 2.50 m
 - 5 Additional protection will be provided when bridge crosses de track:
- 1.40 m height solid railing + 0.40 m height IP2X mesh
- no handrails

REV.	DATE	Description	PRODUCED BY	REVIEWED BY	APPROVED BY
V01	August 2023	Proposed Developments following Railway Order Submissions	GDV	JDR	CCH

© Irish Rail (2023). This drawing is confidential and the copyright in it is owned by Irish Rail. This drawing must not be either loaned, copied or otherwise reproduced in whole or in part or used for any purpose without the prior permission of Irish Rail.
 © Ordnance Survey Ireland and Government of Ireland. All O.S. data used for plans are printed under "Copyright Ordnance Survey Ireland".
 Survey No. 6039720 (OSI Aerial Data or OSI Lidar Data) & Survey No. 2020/OSI/JMA_160 (OSI Vector Data).
 All elevations are in metres and relate to OSI Geoid Model (OSGM02) Mean Head as defined by existing Project Control.
 All Co-ordinates are in Irish Transverse Mercator Grid (ITM) as defined by OSI active GPS station Tallaght College (TLTG).

Client

Tionscatal Éireann
Project Ireland
2040

NTA
Údarás Náisiúnta Iomparáil
National Transport Authority

Iarnród Éireann
Irish Rail

Consultant

IDOM

C3

PROJOD
ROUHAN & O'DONOVAN

Project

DART+
West

Drawing Title

LEVEL CROSSING DESIGN
PORTERSTOWN PEDESTRIAN CROSSING
LONGITUDINAL SECTIONS

Scale: 1:100 @ A1

Drawing Number	Project	Originator	Discipline	Location	Type	Role	Number	Phase
	MAY	MDC	ARC	LC03	DR	A	0004	D

Date:	Job No:	Status:	Rev:
AUGUST 2023	P/101086	S3 - For Review & Comment	V01

Sheet: 1 of 1

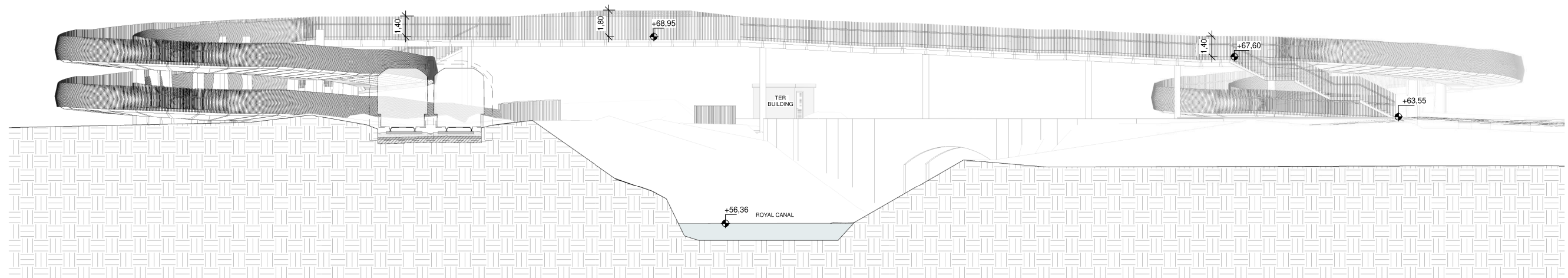
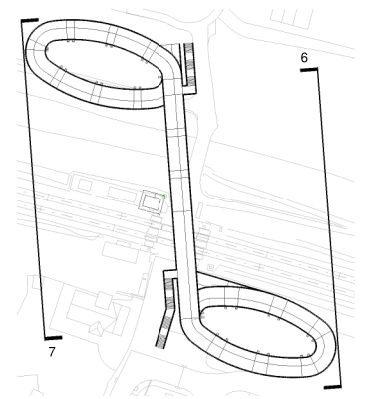

6 | East Elevation
Scale 1 : 150

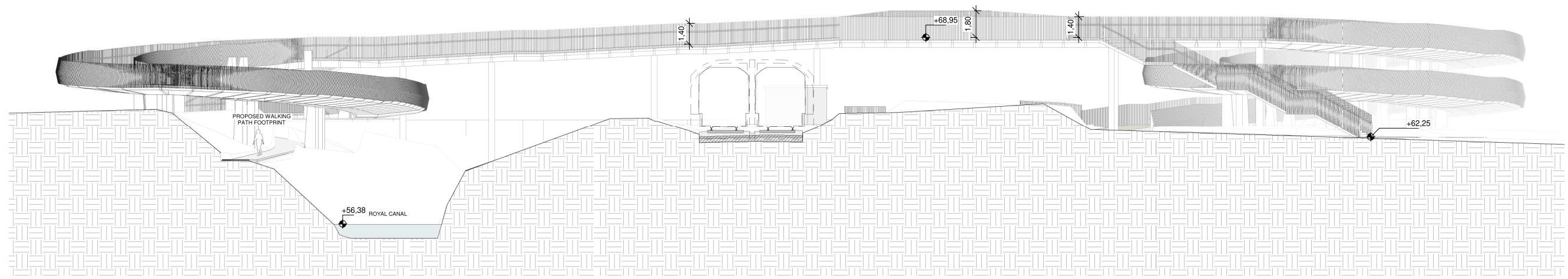

7 | West Elevation
Scale 1 : 150

- NOTES**
- 1 The retaining system will be defined with the input of the Geotechnical Report.
 - 2 The foundation (deep or shallow) will be defined with the input of the Geotechnical Report and the retaining system.
 - 3 Minimum track clearance under the bridge: 5.30 m.
 - 4 Minimum clearance between existing walking path and proposed footbridge: 2.50 m
 - 5 Additional protection will be provided when bridge crosses de track:
- 1.40 m height solid railing + 0.40 m height IP2X mesh
- no handrails

REV.	DATE	DESCRIPTION	PRODUCED BY	REVIEWED BY	APPROVED BY
V01	August 2023	Proposed Developments following Railway Order Submissions	GDV	JDR	CCH

© Irish Rail (2023). This drawing is confidential and the copyright in it is owned by Irish Rail. This drawing must not be either loaned, copied or otherwise reproduced in whole or in part or used for any purpose without the prior permission of Irish Rail.
 © Ordnance Survey Ireland and Government of Ireland. All O.S. data used for plans are printed under "Copyright Ordnance Survey Ireland".
 Survey No. 6039720 (OSI Aerial Data or OSI Lidar Data) & Survey No. 2020/OSI/JMA_160 (OSI Vector Data).
 All elevations are in metres and relate to OSI Geoid Model (OSGM02) Mean Head as defined by existing Project Control.
 All Co-ordinates are in Irish Transverse Mercator Grid (ITM) as defined by OSI active GPS station Tallaght College (TLG).

Client

Consultant

Project

Drawing Title

**LEVEL CROSSING DESIGN
PORTERSTOWN PEDESTRIAN CROSSING
ELEVATION**

Scale: 1:150 @ A1

Drawing Number	Project	Discipline	Location	Type	Role	Number	Phase
	MAY	MDC	ARC	LC03	DR	A	0005 D
Date:	Job No:	Status:	Rev:				
AUGUST 2023	P/101086	S3 - For Review & Comment	V01	Sheet: 1 of 1			

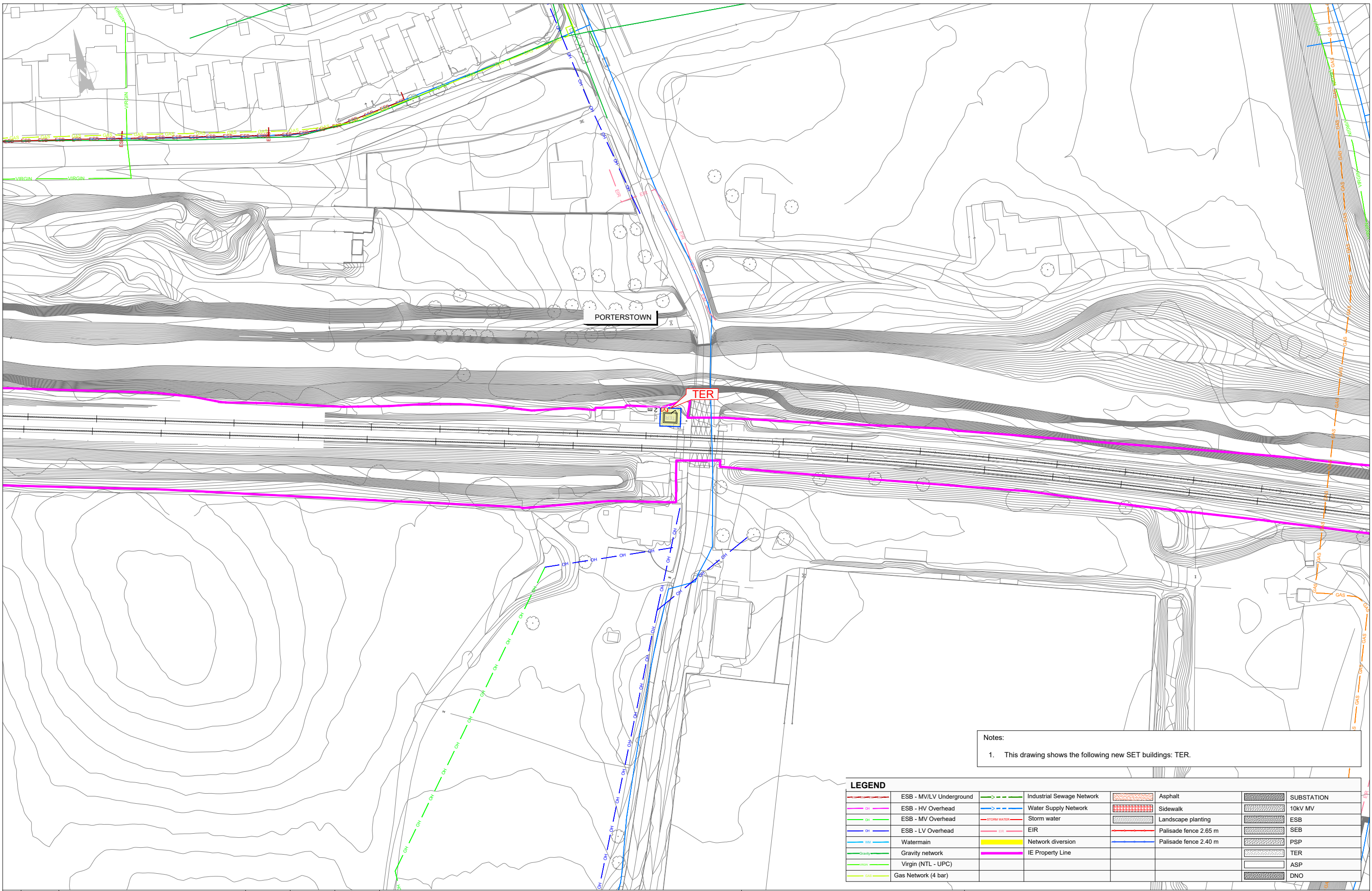

Notes:
 1. This drawing shows the following new SET buildings: TER.

LEGEND			
ESB - MV/LV Underground	Industrial Sewerage Network	Asphalt	SUBSTATION
ESB - HV Overhead	Water Supply Network	Sidewalk	10KV MV
ESB - MV Overhead	Storm water	Landscape planting	ESB
ESB - LV Overhead	EIR	Palisade fence 2.65 m	SEB
Watermain	Network diversion	Palisade fence 2.40 m	PSP
Gravity network	IE Property Line		TER
Virgin (NTL - UPC)			ASP
Gas Network (4 bar)			DNO

Client	Tionscatal Éireann Project Ireland 2040	NTA Údair Náisiúnta Iompartha National Transport Authority	Iarnród Éireann Irish Rail
Consultant	IDOM	G3	PROD
Project	DART+ West		
Drawing Title	SET TECHNICAL BUILDINGS PORTERSTOWN		
Scale:	1:500 @ A1		
Drawing Number	Project	Originator	Discipline
April 2022	MAY MDC	SET	LC06 DR Z
Rev: V01	Job No: P/101086	Status: F1-Approved & accepted	Number: 0003 D
Sheet: 01 of 01	Date: April 2022	Rev: V01	Number: 0003 D

© Irish Rail (2020). This drawing is confidential and the copyright in it is owned by Irish Rail. This drawing must not be either loaned, copied or otherwise reproduced in whole or in part or used for any purpose without the prior permission of Irish Rail.
 © Ordnance Survey Ireland and Government of Ireland. All O.S. data used for plans are printed under "Copyright Ordnance Survey Ireland".
 Survey No. 0039720 (OSi Aerial Data or OSi Lidar Data) & Survey No. 2020/OSI_NMA_180 (OSi Vector Data).
 All elevations are in metres and relate to OSi Geoid Model (OSGM02) Mean Head as defined by existing Project Control.
 All Co-ordinates are in Irish Transverse Mercator Grid (ITM) as defined by OSi active GPS station Tallaght College (TLG0).

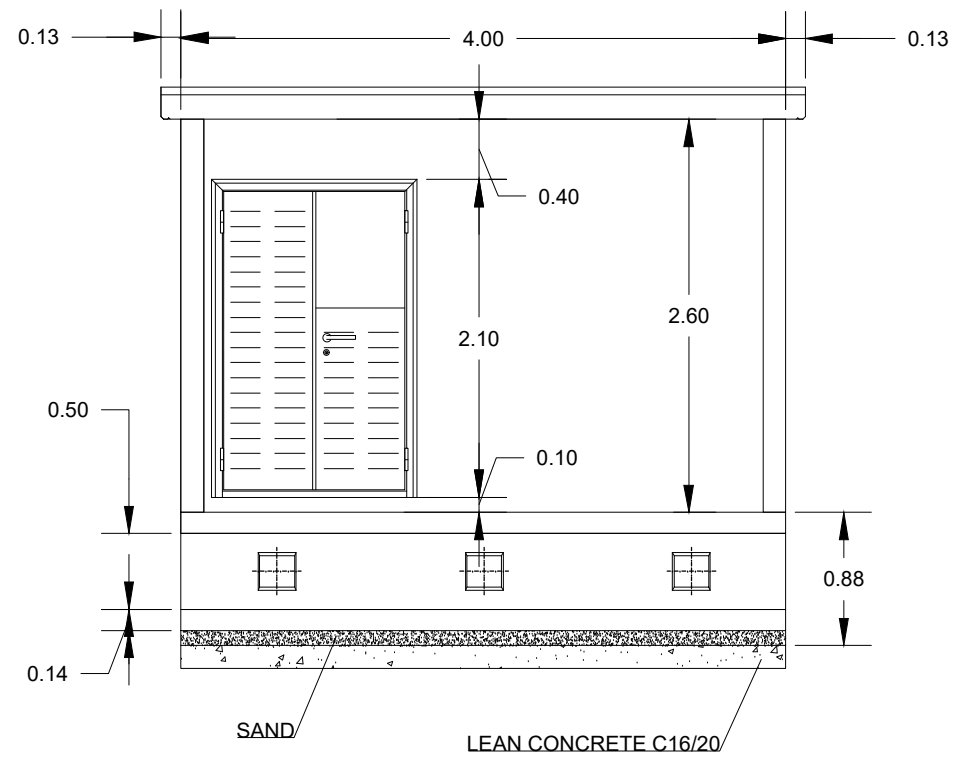

FRONT VIEW

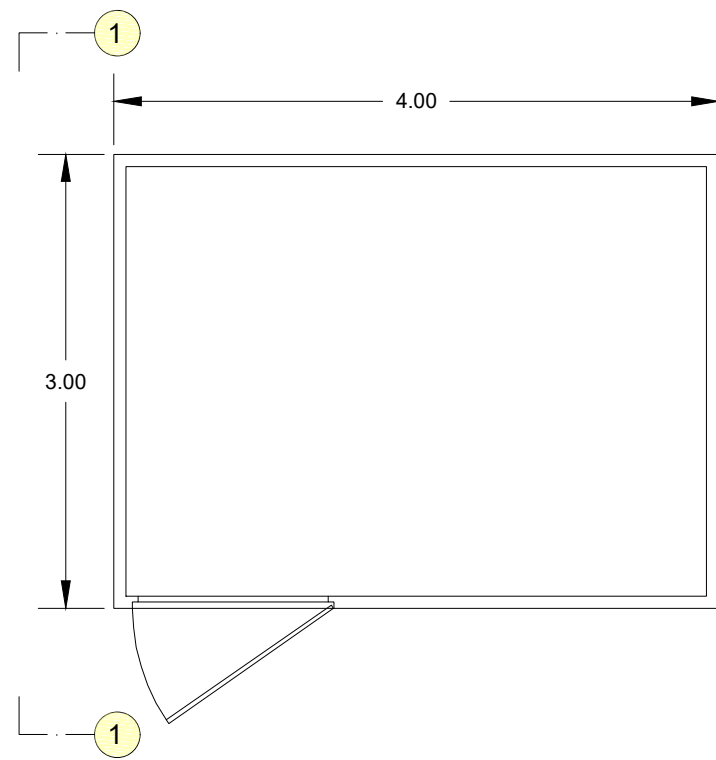

PLANT VIEW

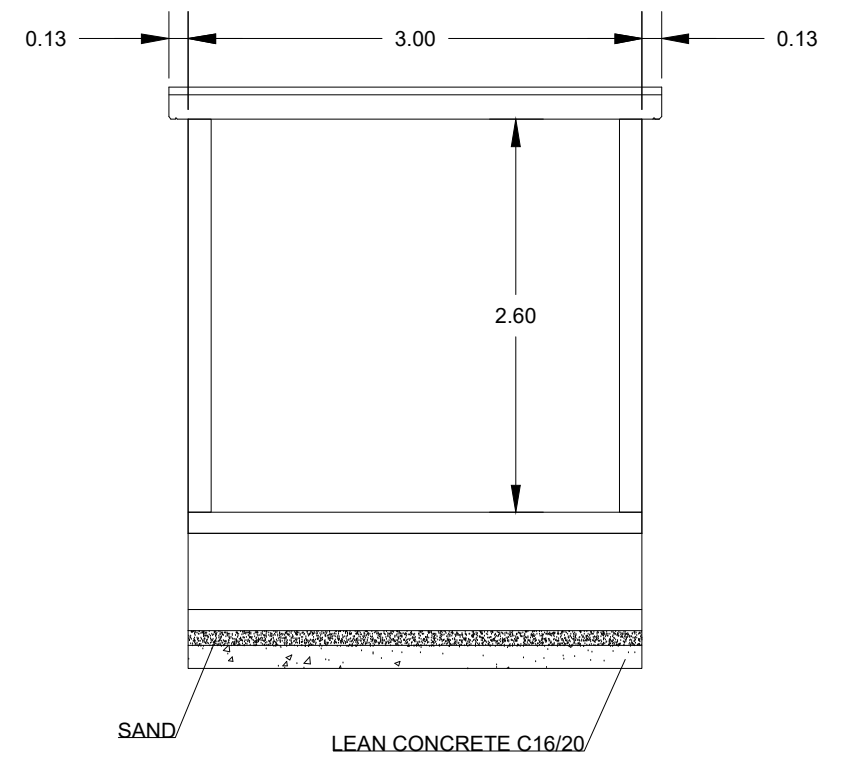

VIEW 1'-1'

TER BUILDING

REV	DATE	DESCRIPTION	PRODUCED BY	REVIEWED BY	APPROVED BY
V01	April 2022	PLANNING ISSUE	MCG	MPT	CCS

© Irish Rail (2022). This drawing is confidential and the copyright in it is owned by Irish Rail. This drawing must not be either loaned, copied or otherwise reproduced in whole or in part or used for any purpose without the prior permission of Irish Rail.
 © Ordnance Survey Ireland and Government of Ireland. All O.S. data used for plans are printed under "Copyright Ordnance Survey Ireland".
 Survey No. 6039720 (OSI Aerial Data or OS Lidar Data) & Survey No. 2020091_NMA_180 (OSI Vector Data).
 All elevations are in metres and relate to OSi Geoid Model1 (OSGM02) Mean-High as defined by existing Project Control.
 All Co-ordinates are in Irish Transverse Mercator Grid (ITM) as defined by OSi active GPS station Tallaght College (TL40).

Client

Consultant

Project

Drawing Title

SET TECHNICAL BUILDINGS
PORTERSTOWN BUILDINGS DETAIL

Scale: 1:20@ A3

Date:	Job No:	Status:	Rev:	Sheet:
April 2022	P/101086	F1-Approved & accepted	V01	01 of 01

Drawing Number | Project | Originator | Discipline | Location | Type | Role | Number | Phase
 MAY MDC SET LC03 DR Z 0010 D