

SHEET 1 OF 2
1:500@A1;1:1000@A3

SHEET 2 OF 2
1:500@A1;1:1000@A3

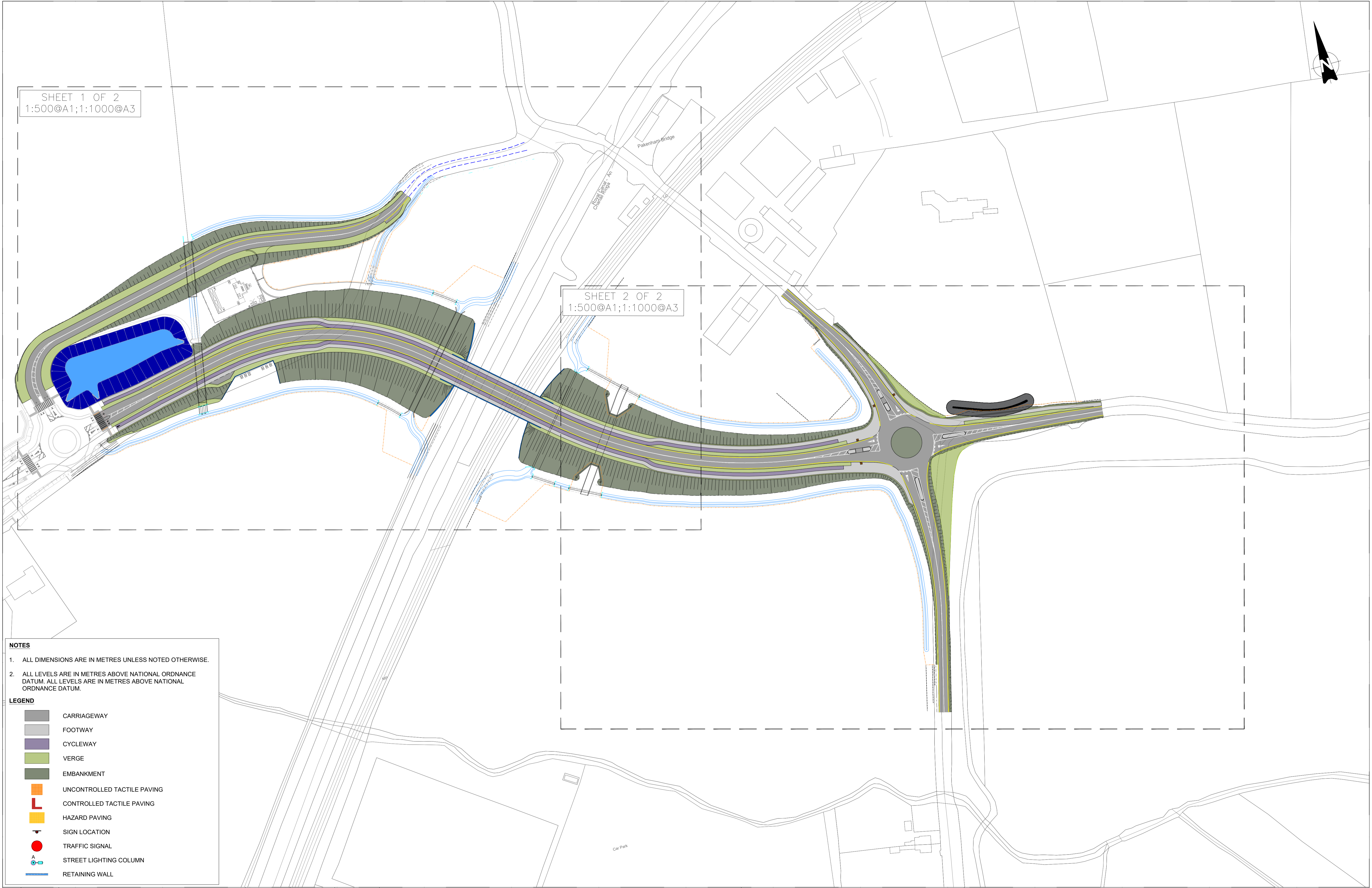

NOTES

- ALL DIMENSIONS ARE IN METRES UNLESS NOTED OTHERWISE.
- ALL LEVELS ARE IN METRES ABOVE NATIONAL ORDNANCE DATUM. ALL LEVELS ARE IN METRES ABOVE NATIONAL ORDNANCE DATUM.

LEGEND

- CARRIAGEWAY
- FOOTWAY
- CYCLEWAY
- VERGE
- EMBANKMENT
- UNCONTROLLED TACTILE PAVING
- CONTROLLED TACTILE PAVING
- HAZARD PAVING
- SIGN LOCATION
- TRAFFIC SIGNAL
- STREET LIGHTING COLUMN
- RETAINING WALL

| | | | | | |
|------|--------------|------------------------------|-------------|-------------|-------------|
| V02 | October 2024 | UPDATED RAILWAY ORDER | RCA | LAN | CCH |
| V01 | April 2022 | PHASE 3 - PRELIMINARY DESIGN | CB | TL | MK |
| REV. | DATE | DESCRIPTION | PRODUCED BY | REVIEWED BY | APPROVED BY |

© Irish Rail (2021). This drawing is confidential and the copyright in it is owned by Irish Rail. This drawing must not be either loaned, copied or otherwise reproduced in whole or in part or used for any purpose without the prior permission of Irish Rail.
 © Ordnance Survey Ireland and Government of Ireland. All O.S. data used for plans are printed under "Copyright Ordnance Survey Ireland".
 Survey No. 0039721 (OSi Aerial Data or OSi Lidar Data) & Survey No. 2021051_NMA_180 (OSi Vector Data).
 All elevations are in metres and relate to OSi Geoid Model (OSGM02) Mean Head as defined by existing Project Control.
 All Co-ordinates are in Irish Transverse Mercator Grid (ITM) as defined by OSi active GPS station Tallaght College (TLTG).

Client

Tionscadal Éireann Project Ireland 2040

NTA Údarás Náisiúnta Iompair National Transport Authority

Iarnród Éireann Irish Rail

Consultant

IDOM

G3

PROJ ROD ROUGHAN & O'DONOVAN

Project

DART+ West

Drawing Title

ROADWORKS DESIGN - LC05: BARBERSTOWN
GENERAL ARRANGEMENT - PLAN
SHEET LAYOUT

Scale: 1:250 @ A1 1:500 @ A3

Drawing Number | Project | Originator | Discipline | Location | Type | Role | Number | Phase

MAY | HRW | LC05 | DR | C | 0100 | C

Date: October 2024 | Job No: P/101086 | Status: F1 - Approved & Accepted | Rev: V 02 | Sheet: 01 of 01

NOTES

1. ALL DIMENSIONS ARE IN METRES UNLESS NOTED OTHERWISE.
2. ALL LEVELS ARE IN METRES ABOVE NATIONAL ORDNANCE DATUM. ALL LEVELS ARE IN METRES ABOVE NATIONAL ORDNANCE DATUM.

LEGEND

- CARRIAGEWAY
- FOOTWAY
- CYCLEWAY
- VERGE
- EMBANKMENT
- UNCONTROLLED TACTILE PAVING
- CONTROLLED TACTILE PAVING
- HAZARD PAVING
- SIGN LOCATION
- TRAFFIC SIGNAL
- STREET LIGHTING COLUMN
- RETAINING WALL

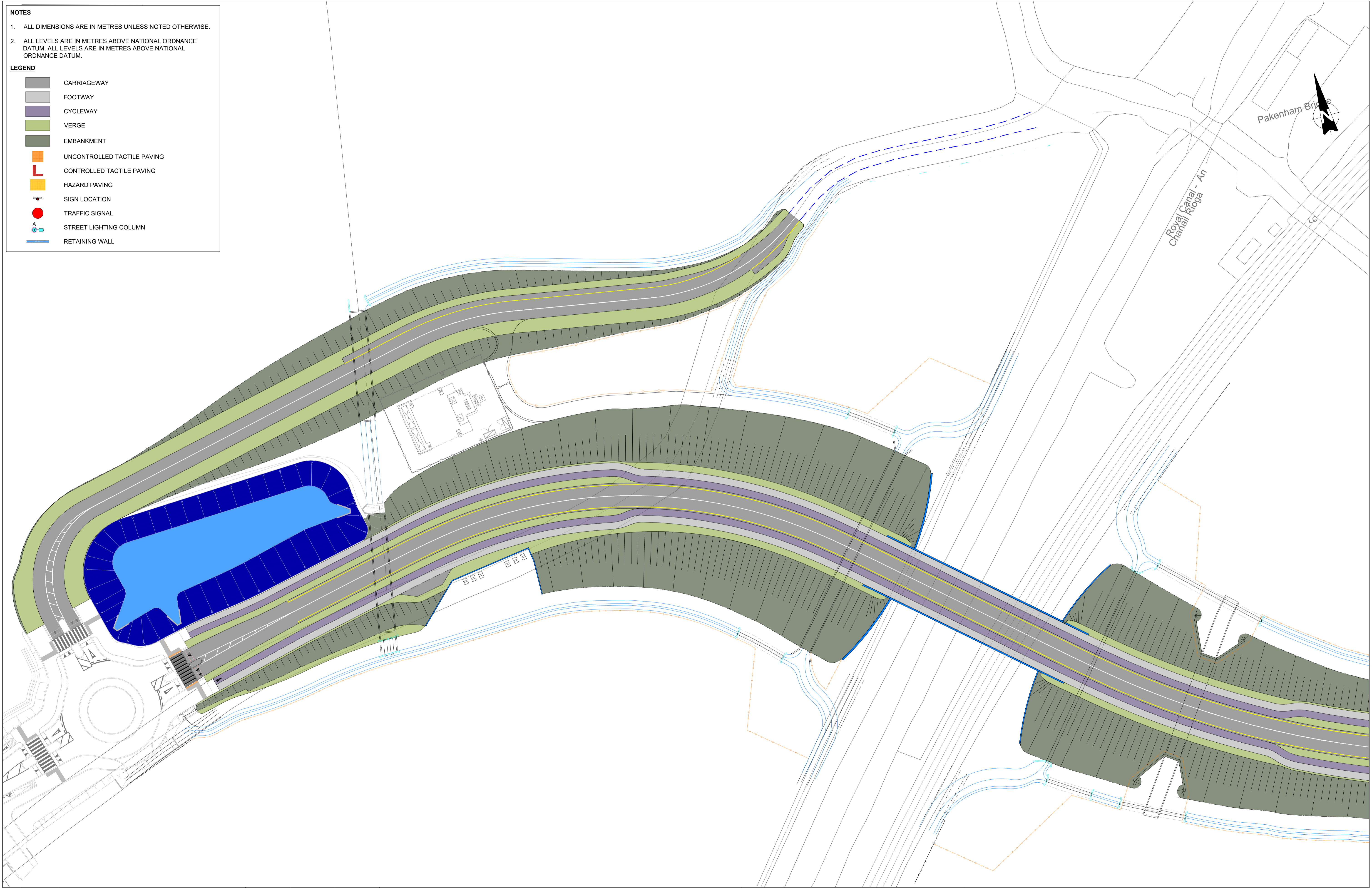

| | | | | | |
|------|--------------|------------------------------|-------------|-------------|-------------|
| V02 | October 2024 | UPDATED RAILWAY ORDER | RCA | LAN | CCH |
| V01 | April 2022 | PHASE 3 - PRELIMINARY DESIGN | CB | TL | MK |
| REV. | DATE | DESCRIPTION | PRODUCED BY | REVIEWED BY | APPROVED BY |

© Irish Rail (2021). This drawing is confidential and the copyright in it is owned by Irish Rail. This drawing must not be either loaned, copied or otherwise reproduced in whole or in part or used for any purpose without the prior permission of Irish Rail.
 © Ordnance Survey Ireland and Government of Ireland. All O.S. data used for plans are printed under "Copyright Ordnance Survey Ireland".
 Survey No. 0039721 (OSI Aerial Data or OSi Lidar Data) & Survey No. 2021/051_NMA_180 (OSi Vector Data).
 All elevations are in metres and relate to OSi Geoid Model (OSGM02) Mean Head as defined by existing Project Control.
 All Co-ordinates are in Irish Transverse Mercator Grid (ITM) as defined by OSi active GPS station Tallaght College (TLTG).

Client

Tionscald Éireann
Project Ireland
2040

NTA
Údaráis Náisiúnta Iompair
National Transport Authority

Iarnród Éireann
Irish Rail

Consultant

IDOM

G3

PROD

ROUHRAN & O'DONOVAN

Project

DART+
West

Drawing Title

ROADWORKS DESIGN - LC05: BARBERSTOWN
GENERAL ARRANGEMENT - PLAN
SHEET 1 OF 2

Scale:
1:250 @ A1 1:500 @ A3

Drawing Number | Project | Originator | Discipline | Location | Type | Role | Number | Phase
MAY MDC HRW LC05 DR C 0101 C

Date: October 2024 | Job No: P/101086 | Status: F1 - Approved & Accepted | Rev: V 02 | Sheet: 01 of 02



NOTES

- ALL DIMENSIONS ARE IN METRES UNLESS NOTED OTHERWISE.
- ALL LEVELS ARE IN METRES ABOVE NATIONAL ORDNANCE DATUM. ALL LEVELS ARE IN METRES ABOVE NATIONAL ORDNANCE DATUM.

LEGEND

- CARRIAGEWAY
- FOOTWAY
- CYCLEWAY
- VERGE
- EMBANKMENT
- UNCONTROLLED TACTILE PAVING
- CONTROLLED TACTILE PAVING
- HAZARD PAVING
- SIGN LOCATION
- TRAFFIC SIGNAL
- STREET LIGHTING COLUMN
- RETAINING WALL

| | | | | | |
|------|--------------|------------------------------|-------------|-------------|-------------|
| V02 | October 2024 | UPDATED RAILWAY ORDER | RCA | LAN | CCH |
| V01 | April 2022 | PHASE 3 - PRELIMINARY DESIGN | CB | TL | MK |
| REV. | DATE | DESCRIPTION | PRODUCED BY | REVIEWED BY | APPROVED BY |

© Irish Rail (2021). This drawing is confidential and the copyright in it is owned by Irish Rail. This drawing must not be either loaned, copied or otherwise reproduced in whole or in part or used for any purpose without the prior permission of Irish Rail.
 © Ordnance Survey Ireland and Government of Ireland. All O.S. data used for plans are printed under "Copyright Ordnance Survey Ireland".
 Survey No. 0039721 (OSI Aerial Data or OSI Lidar Data) & Survey No. 2021/OSI_NMA_180 (OSI Vector Data).
 All elevations are in metres and relate to OSI Geoid Model (OSGM02) Mean Head as defined by existing Project Control.
 All Co-ordinates are in Irish Transverse Mercator Grid (ITM) as defined by OSI active GPS station Tallaght College (TLG).

Client





Consultant





Project



Drawing Title

ROADWORKS DESIGN - LC05: BARBERSTOWN
GENERAL ARRANGEMENT - PLAN
SHEET 2 OF 2

Scale: 1:250 @ A1 1:500 @ A3



| | | | | | | | | |
|----------------|----------|--------------------------|------------|----------|------|------|--------|-------|
| Drawing Number | Project | Originator | Discipline | Location | Type | Role | Number | Phase |
| MAY | MDC | HRW | LC05 | DR | C | 0102 | C | C |
| Date: | Job No: | Status: | Rev: | Sheet: | | | | |
| October 2024 | P/101086 | F1 - Approved & Accepted | V 02 | 02 of 02 | | | | |

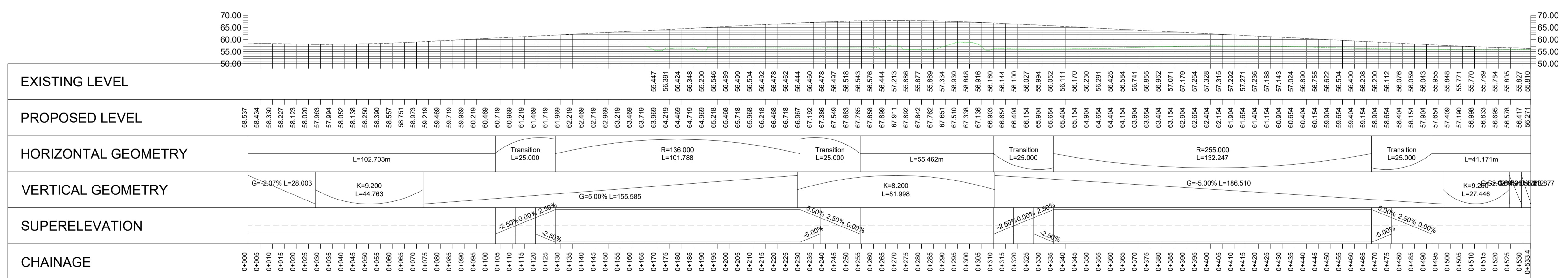
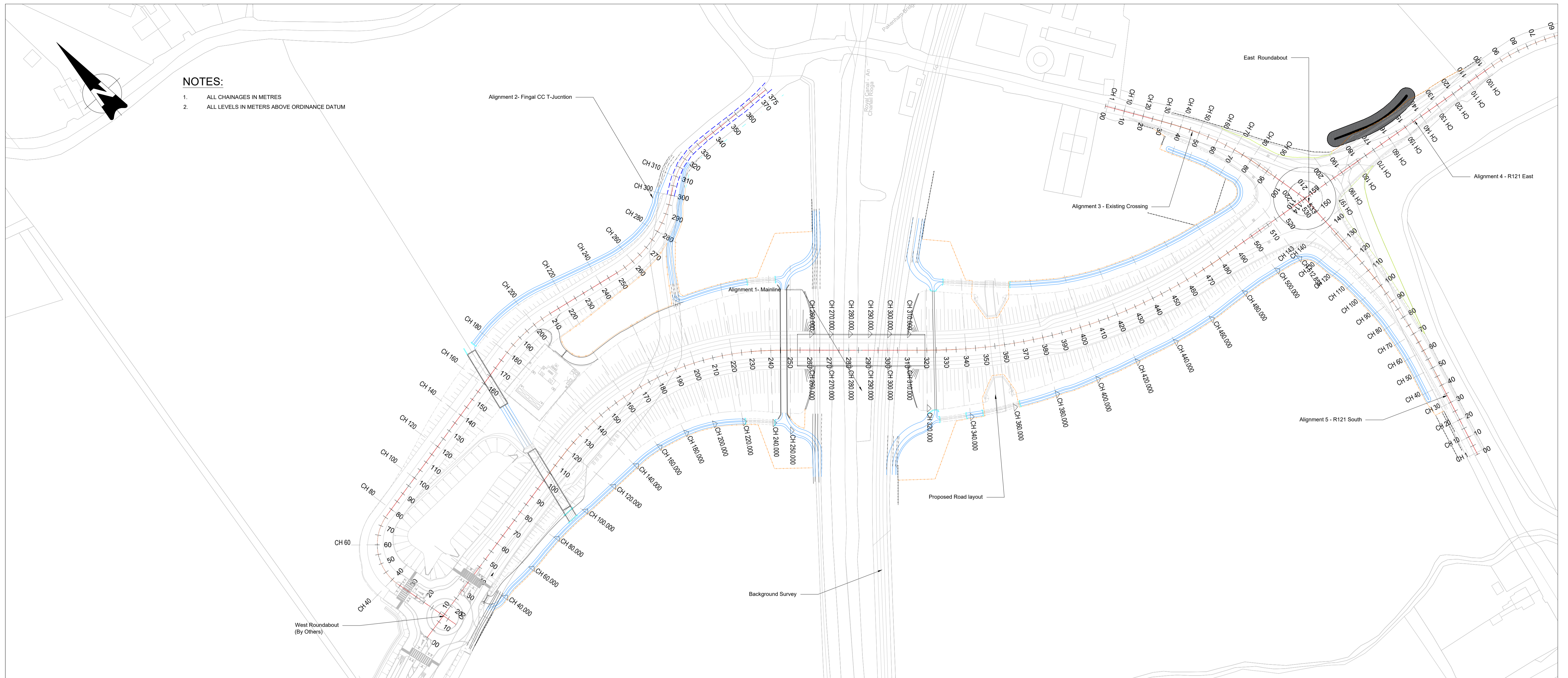

LONGSECTION- ALIGNMENT 1- MAINLINE PROFILE

LEGEND:

- PROPOSED ROAD CENTRELINE PROFILE
- EXISTING ROAD CENTRELINE PROFILE

| | | | | | |
|------|--------------|-----------------------|-------------|-------------|-------------|
| V02 | October 2024 | UPDATED RAILWAY ORDER | RCA | LAN | CCH |
| V01 | April 2022 | PLANNING ISSUE | CB | TL | MK |
| REV. | DATE | DESCRIPTION | PRODUCED BY | REVIEWED BY | APPROVED BY |

© Irish Rail (2021). This drawing is confidential and the copyright in it is owned by Irish Rail. This drawing must not be either loaned, copied or otherwise reproduced in whole or in part or used for any purpose without the prior permission of Irish Rail.
 © Ordnance Survey Ireland and Government of Ireland. All O.S. data used for plans are printed under "Copyright Ordnance Survey Ireland"
 Survey No. 0039721 (OSI Aerial Data or OSI L50r Data) & Survey No. 2021V05I_NMA_180 (OSI Vector Data).
 All elevations are in metres and relate to OSI Geoid Model (OSGM02) Malin Head as defined by existing Project Control.
 All Co-ordinates are in Irish Transverse Mercator Grid (ITM) as defined by OSI active GPS station Tallaght College (TLG).

Client
 Tionscatal Eireann
 Project Ireland
 2040

NTA
 Údarás Náisiúnta Iompair
 National Transport Authority

lanróid Eireann
 Irish Rail

Consultant
 IDOM
 C3
 FROD
 ROYBURN & O'DONOVAN

Project
 DART+
 West

Drawing Title
 ROADWORKS DESIGN - LC05: BARBERSTOWN
 ROAD ALIGNMENT PROPOSED
 SHEET 1 OF 3

Scale:
 1:250 @ A1 1:500 @ A3

Drawing Number | Project | Originator | Discipline | Location | Type | Role | Number | Phase
 MAY | MDC | HRW | LC05 | DR | C | 0104 | D

Date: October 2024 | Job No: P/101086 | Status: F1 - Approved & Accepted | Rev: V 02 | Sheet: 01 of 03

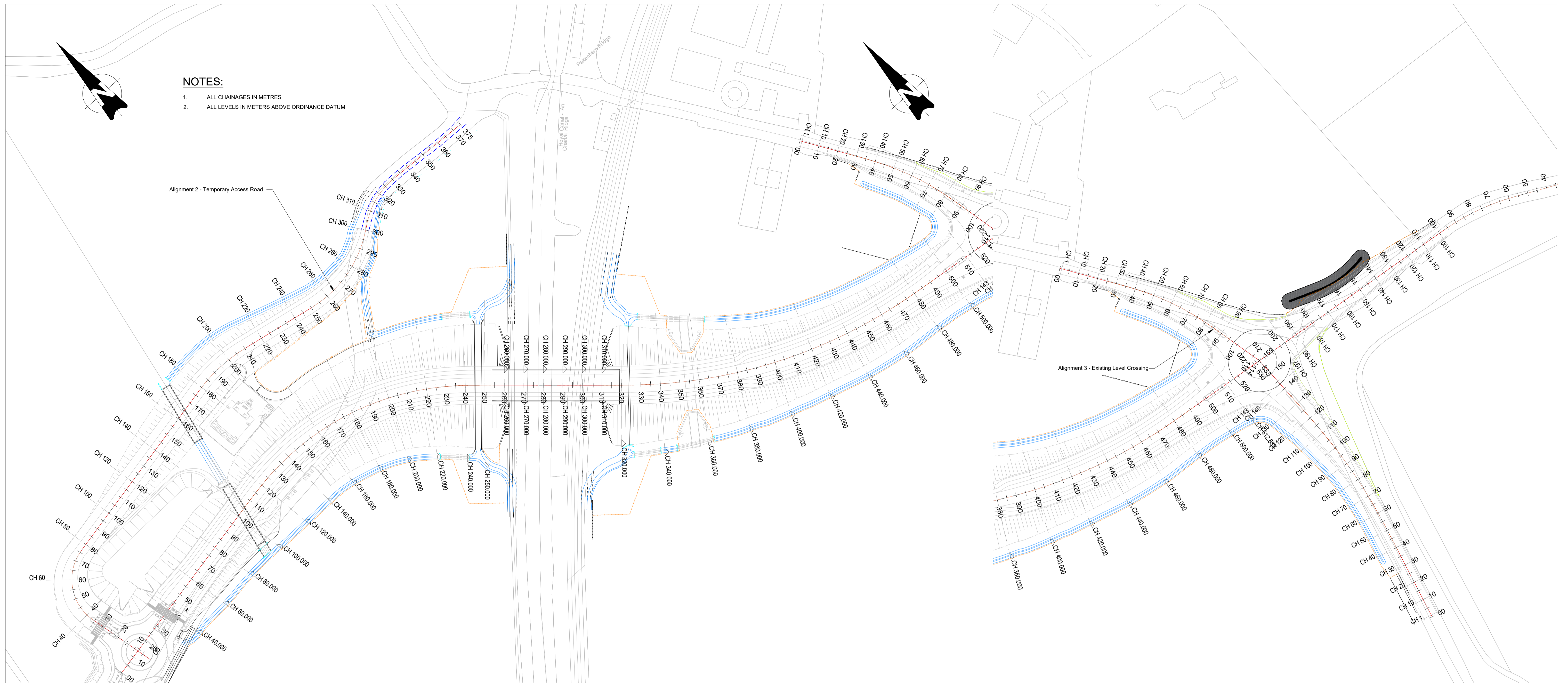

- NOTES:**
- ALL CHAINAGES IN METRES
 - ALL LEVELS IN METERS ABOVE ORDINANCE DATUM

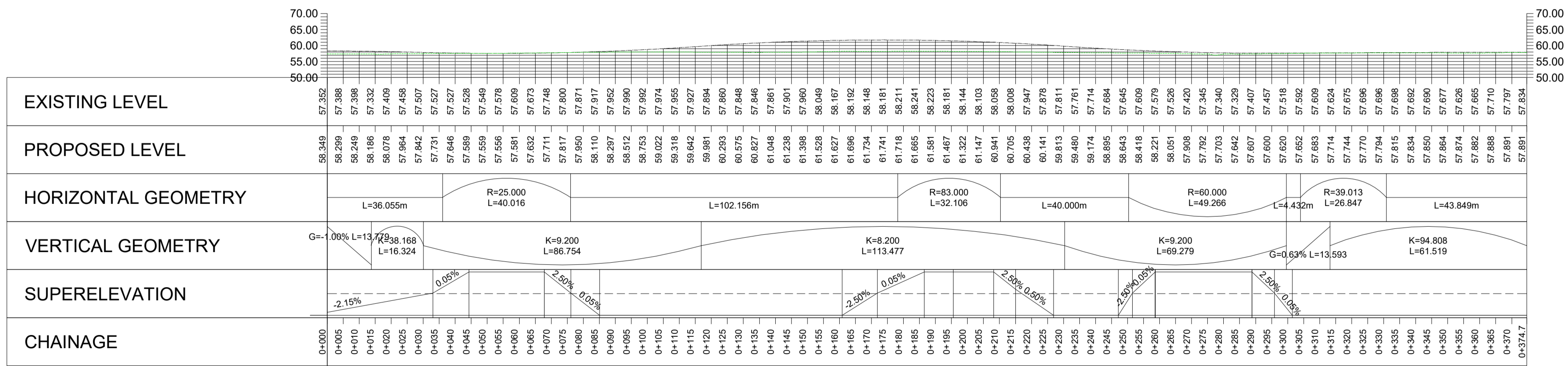

ALIGNMENT 2 - TEMPORARY ACCESS ROAD PROFILE

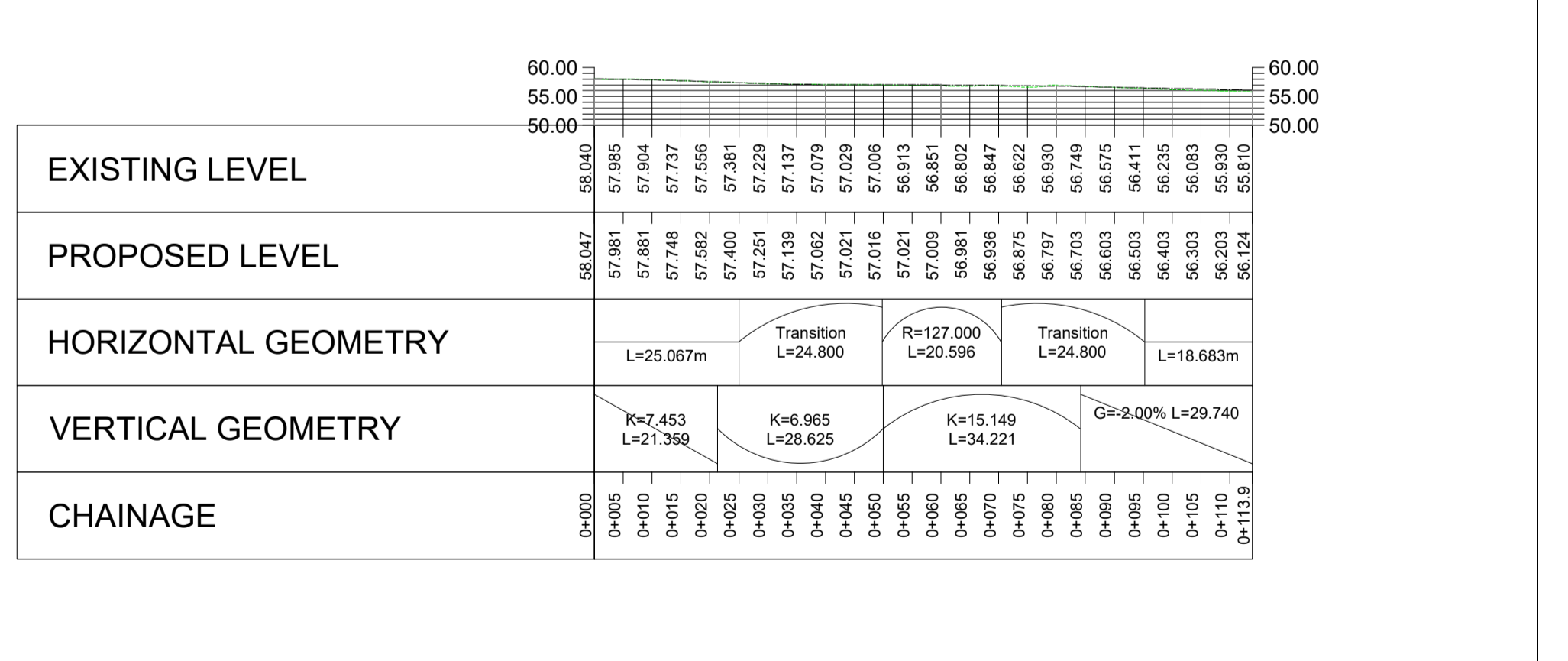

ALIGNMENT 3- EXISTING LEVEL CROSSING PROFILE

- LEGEND:**
- PROPOSED ROAD CENTRELINE PROFILE
 - EXISTING ROAD CENTRELINE PROFILE

| | | | | | |
|------|--------------|-----------------------|-------------|-------------|-------------|
| V02 | October 2024 | UPDATED RAILWAY ORDER | RCA | LAN | CCH |
| V01 | April 2022 | PLANNING ISSUE | CB | TL | MK |
| REV. | DATE | DESCRIPTION | PRODUCED BY | REVIEWED BY | APPROVED BY |

© Irish Rail (2021). This drawing is confidential and the copyright in it is owned by Irish Rail. This drawing must not be copied or otherwise reproduced in whole or in part or used for any purpose without the prior permission of Irish Rail.
 © Ordnance Survey Ireland and Government of Ireland. All O.S. data used for plans are printed under "Copyright Ordnance Survey Ireland" Survey No. 0039721 (OSI Aerial Data or OSI L3dA Data) & Survey No. 2021051_NMA_180 (OSI Vector Data).
 All elevations are in metres and relate to OSI Geoid Model (OSGM02) Malin Head as defined by existing Project Control.
 All Co-ordinates are in Irish Transverse Mercator Grid (ITM) as defined by OSI active GPS station Tallaght College (TLG).

Client

Consultant

Project

Drawing Title

ROADWORKS DESIGN - LC05: BARBERSTOWN
ROAD ALIGNMENT PROPOSED
SHEET 2 OF 3

Scale: 1:250 @ A1 1:500 @ A3

Drawing Number | Project | Originator | Discipline | Location | Type | Role | Number | Phase

MAY MDC HRW LC05 DR C 0105 D

Date: October 2024 Job No: P/101086 Status: F1 - Approved & Accepted Rev: V 02 Sheet: 02 of 03

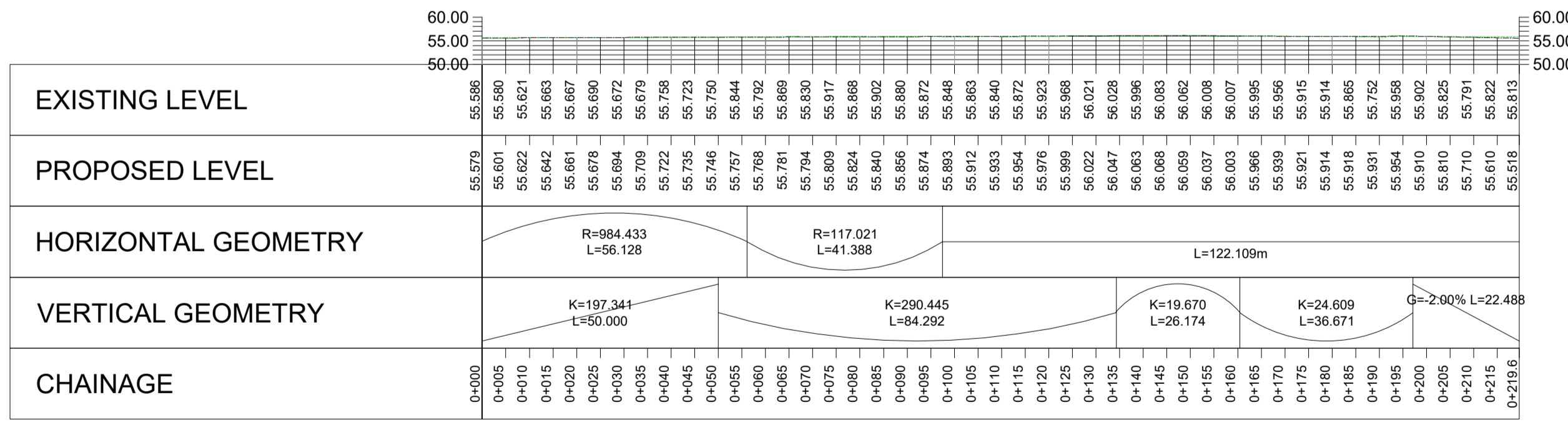
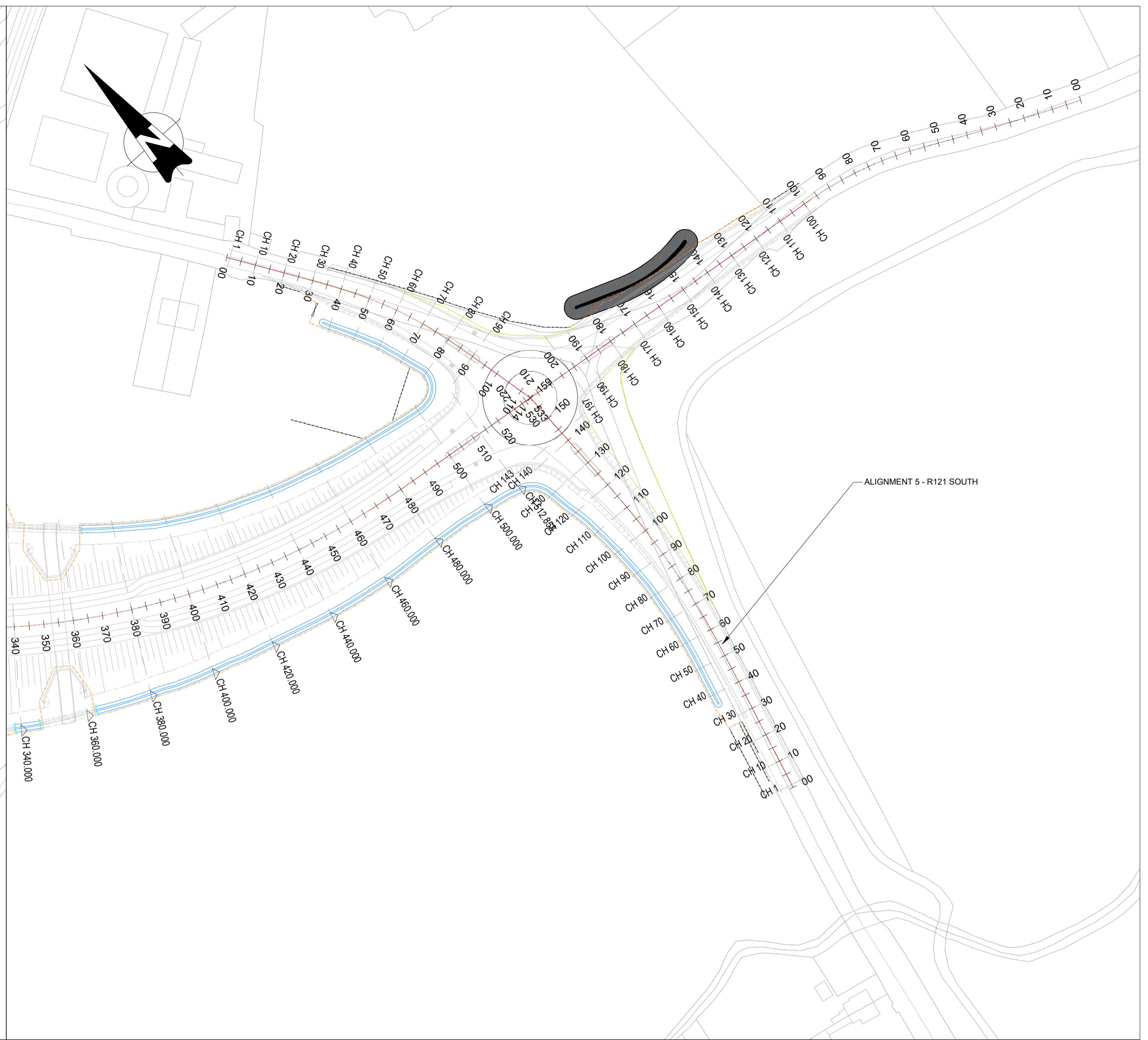
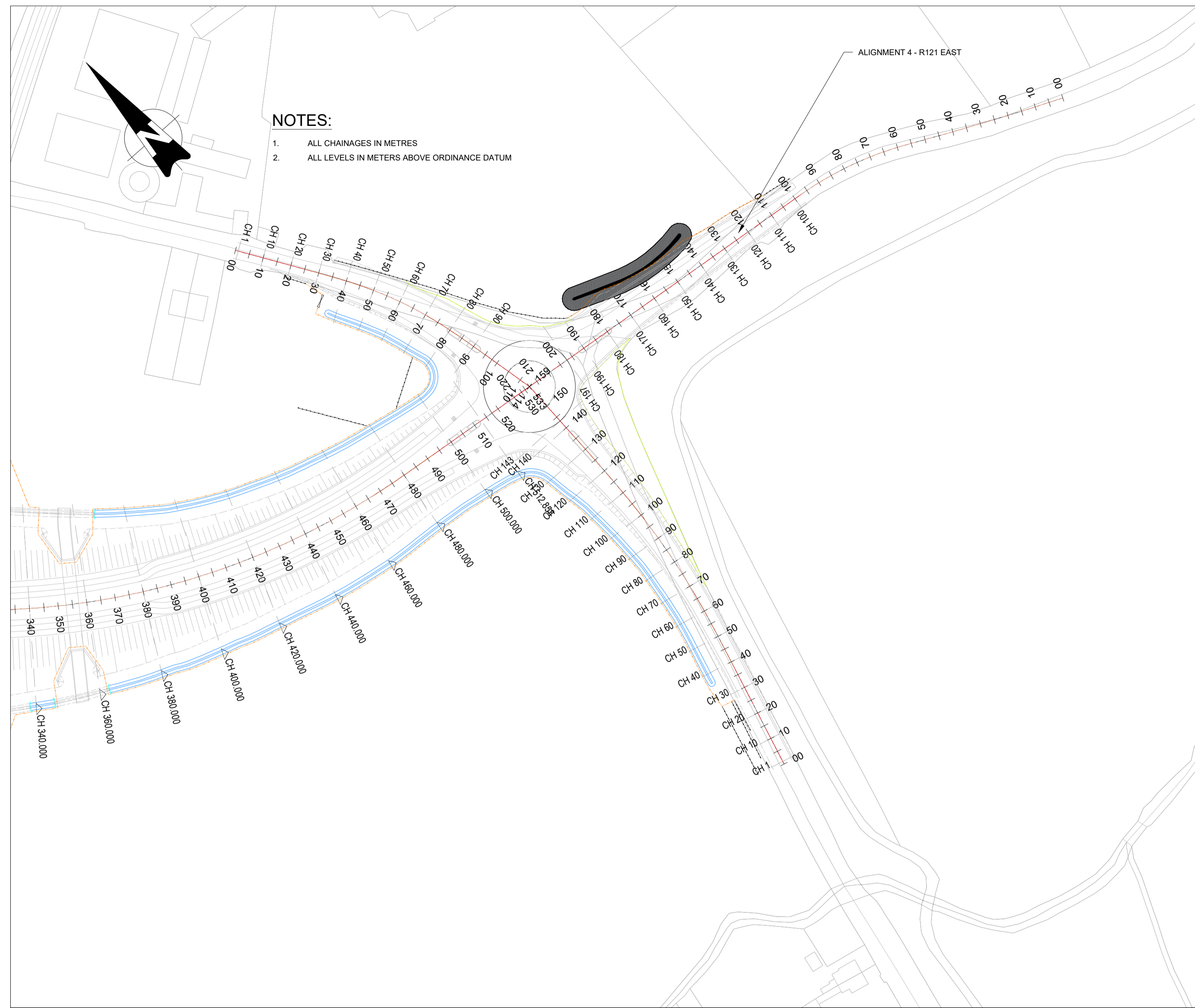

ALIGNMENT 4 - R121 EAST PROFILE

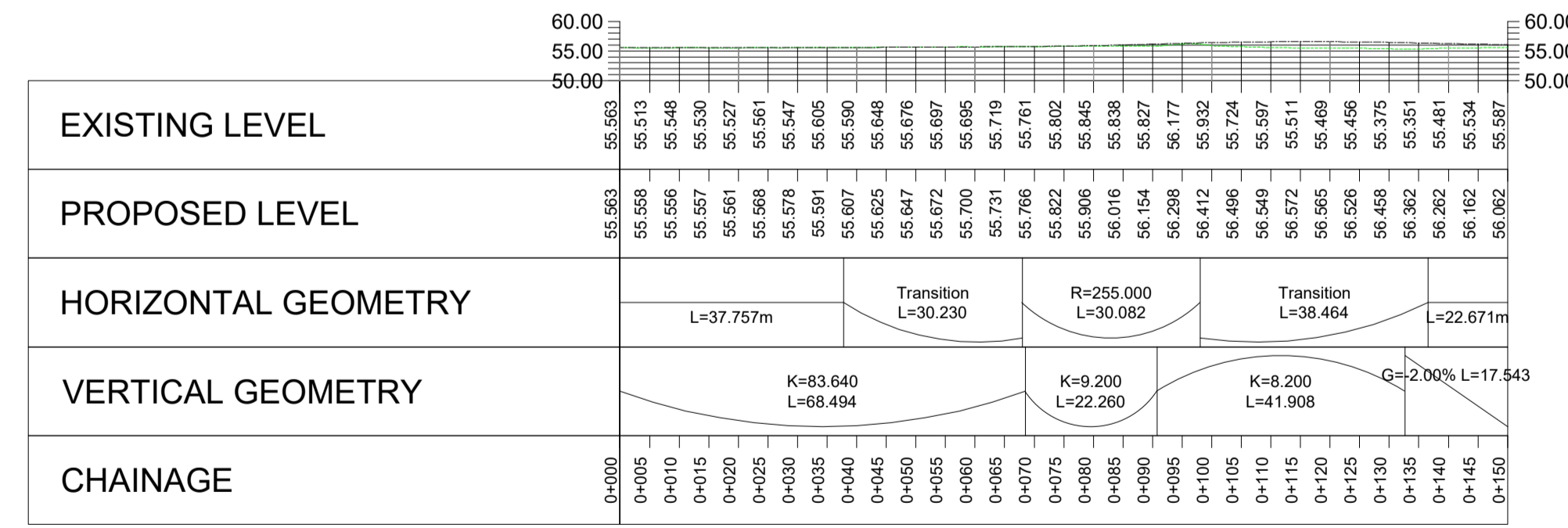

ALIGNMENT 5 - R121 SOUTH PROFILE

LEGEND:

- PROPOSED ROAD CENTRELINE PROFILE
- EXISTING ROAD CENTRELINE PROFILE

| | | | | | |
|------|--------------|-----------------------|-------------|-------------|-------------|
| V02 | October 2024 | UPDATED RAILWAY ORDER | RCA | LAN | CCH |
| V01 | April 2022 | PLANNING ISSUE | CB | TL | MK |
| REV. | DATE | DESCRIPTION | PRODUCED BY | REVIEWED BY | APPROVED BY |

© Irish Rail (2021). This drawing is confidential and the copyright in it is owned by Irish Rail. This drawing must not be either loaned, copied or otherwise reproduced in whole or in part or used for any purpose without the prior permission of Irish Rail.
 © Ordnance Survey Ireland and Government of Ireland. All O.S. data used for plans are printed under "Copyright Ordnance Survey Ireland" Survey No. 0039721 (OSI Aerial Data or OSI Lidar Data) & Survey No. 2021OSI_NMA_180 (OSI Vector Data).
 All elevations are in metres and relate to OSI Geoid Model (OSGM02) Malin Head as defined by existing Project Control.
 All Co-ordinates are in Irish Transverse Mercator Grid (ITM) as defined by OSI active GPS station Tallaght College (TLG).

Client

Tionscatal Eireann
Project Ireland
2040

NTA
Údarás Náisiúnta Iompair
National Transport Authority

Iarnród Éireann
Irish Rail

Consultant

IDOM

C3

FIROD
KOURBAN & O'DONOVAN

Project

DART+
West

Drawing Title

ROADWORKS DESIGN - LC05: BARBERSTOWN
ROAD ALIGNMENT PROPOSED
SHEET 1 OF 3

Scale:
1:250 @ A1 1:500 @ A3

Drawing Number | Project | Originator | Discipline | Location | Type | Role | Number | Phase
MAY MDC HRW LC05 DR C 0106 D

Date: October 2024 Job No: P/101086 Status: F1 - Approved & Accepted Rev: V 02 Sheet: 03 of 03

ALIGNMENT 1
MAINLINE
SCALE 1:40
SECTION A-A
C.L.

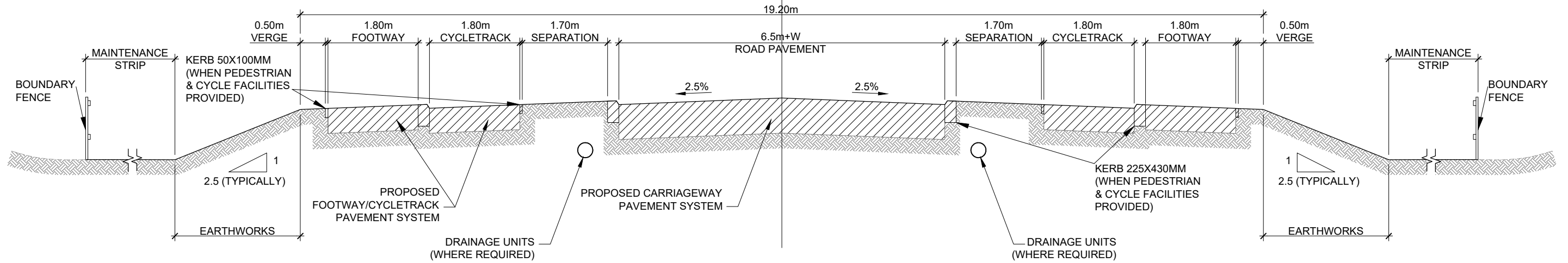

ALIGNMENT 2
TEMPORARY ACCESS ROAD
SCALE 1:40
SECTION B-B
C.L.

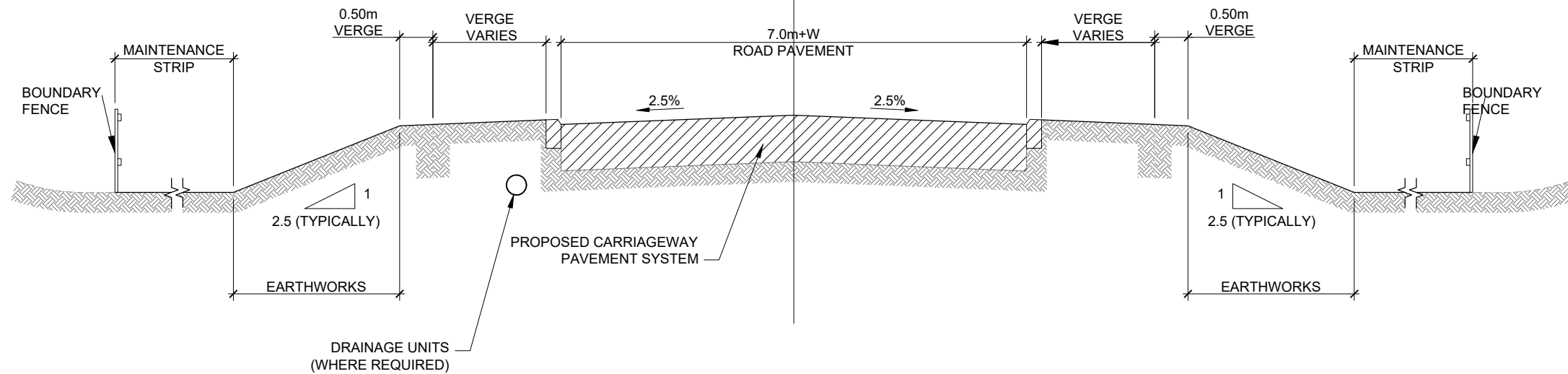

NOTE:
W - Widening on curves

| | | | | | | | | | | | |
|---|--|--|--|------------------|--|--|--|--|--|--|--|
| Client | | | | Project | | | | Drawing Title | | | |
| | | | | | | | | ROADWORKS DESIGN - LC05: BARBERSTOWN TYPICAL CROSS SECTIONS SHEET 1 OF 1 | | | |
| PRODUCED BY: CB REVIEWED BY: TL APPROVED BY: MK | | | | Consultant: | | | | Scale: 1:40 @ A1 1:80 @ A3 | | | |
| Date: April 2022 | | | | Job No: P/101086 | | | | Date: April 2022 Job No: P/101086 Status: F1 - Approved & Accepted Rev: V 01 Sheet: 01 of 01 | | | |

NOTES

1. ALL DIMENSIONS ARE IN MILLIMETRES UNLESS NOTED OTHERWISE
2. ALL CHAINAGES ARE IN METRES
3. ALL LEVELS IN METRES ABOVE ORDNANCE DATUM MALIN
4. PROPOSED OHLE NOT SHOWN - TBC

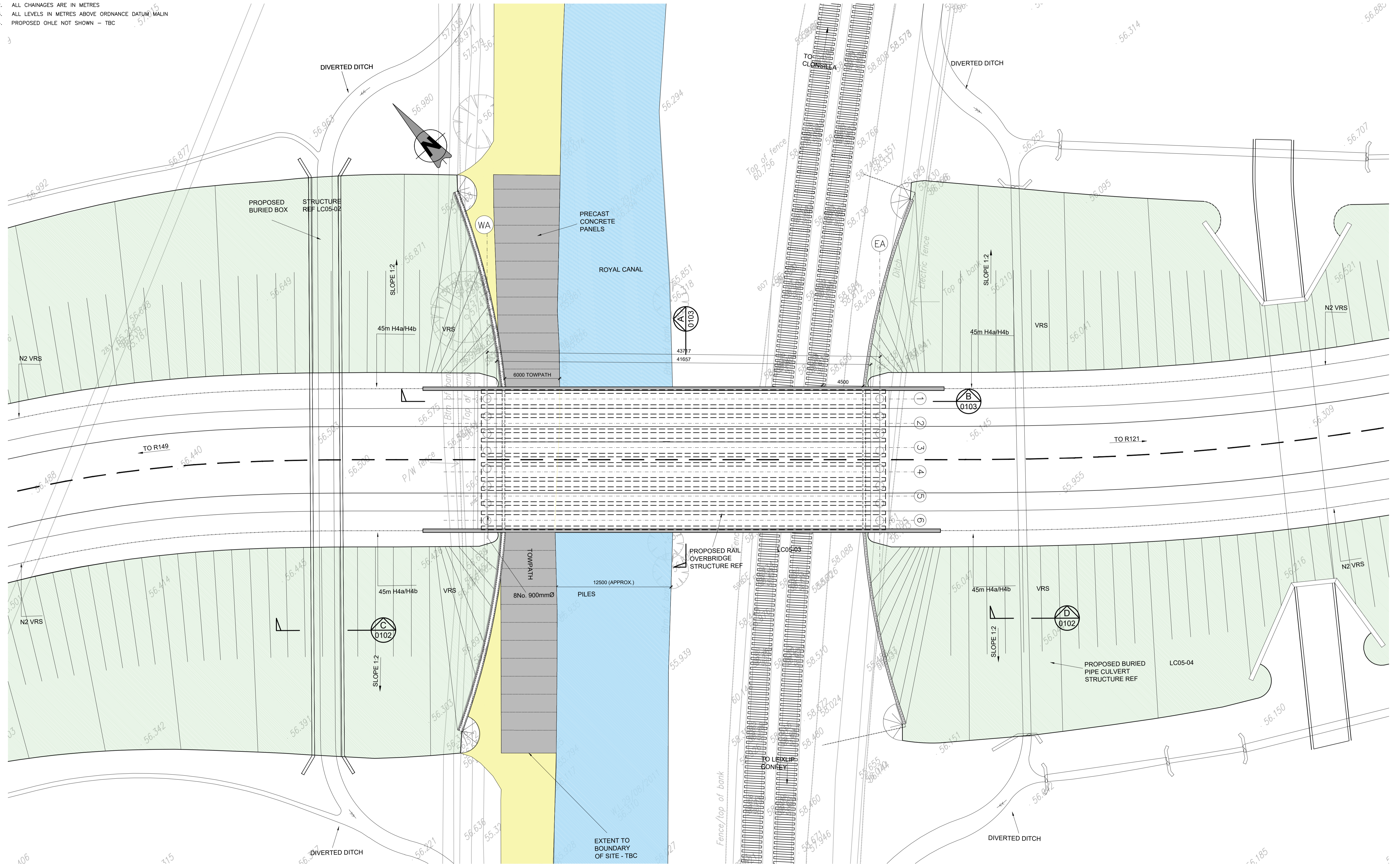

PLAN
SCALE 1:200 A1
SCALE 1:400 A3

| | | | | | |
|------|--------------|-----------------------|-------------|-------------|-------------|
| V03 | October 2024 | UPDATED RAILWAY ORDER | RCA | LAN | CCH |
| V02 | August 2021 | PRELIMINARY DESIGN | IT | PC | TL |
| V01 | July 2021 | PRELIMINARY DESIGN | IT | TL | MK |
| REV. | DATE | DESCRIPTION | PRODUCED BY | REVIEWED BY | APPROVED BY |

© Irish Rail (2021). This drawing is confidential and the copyright in it is owned by Irish Rail. This drawing must not be either loaned, copied or otherwise reproduced in whole or in part or used for any purpose without the prior permission of Irish Rail.
© Ordnance Survey Ireland and Government of Ireland. All O.S. data used for plans are printed under "Copyright Ordnance Survey Ireland".
Survey No. 0039721 (OSi Aerial Data or OSi Lidar Data) & Survey No. 2021081_NMA_180 (OSi Vector Data).
All elevations are in metres and relate to OSi Geoid Model (OSGM02) Malin Head as defined by existing Project Control.
All Co-ordinates are in Irish Transverse Mercator Grid (ITM) as defined by OSi active GPS station Tallaght College (TLG).

Client

Tionscatal Éireann
Project Ireland
2040

NTA
Udarás Náisiúnta Iompartha
National Transport Authority

Iarnród Éireann
Irish Rail

Consultant

IDOM

G3

PROD

ROGHAN & O'DONOVAN

Project

DART+
West

Drawing Title

STRUCTURES DESIGN - LC05: BARBERSTOWN
BRIDGE GENERAL ARRANGEMENT - PLAN
SHEET 1 OF 3

Scale:
1:200 @ A1

Drawing Number | Project | Originator | Discipline | Location | Type | Role | Number | Phase
MAY MDC STR LC05 DR C 0201 C

Date: October 2024 | Job No: P/101086 | Status: F1 - Approved & Accepted | Rev: V 03 | Sheet: 01 of 03

NOTES

1. ALL DIMENSIONS ARE IN MILLIMETRES UNLESS NOTED OTHERWISE
2. ALL CHAINAGES ARE IN METRES
3. ALL LEVELS IN METRES ABOVE ORDNANCE DATUM MALIN

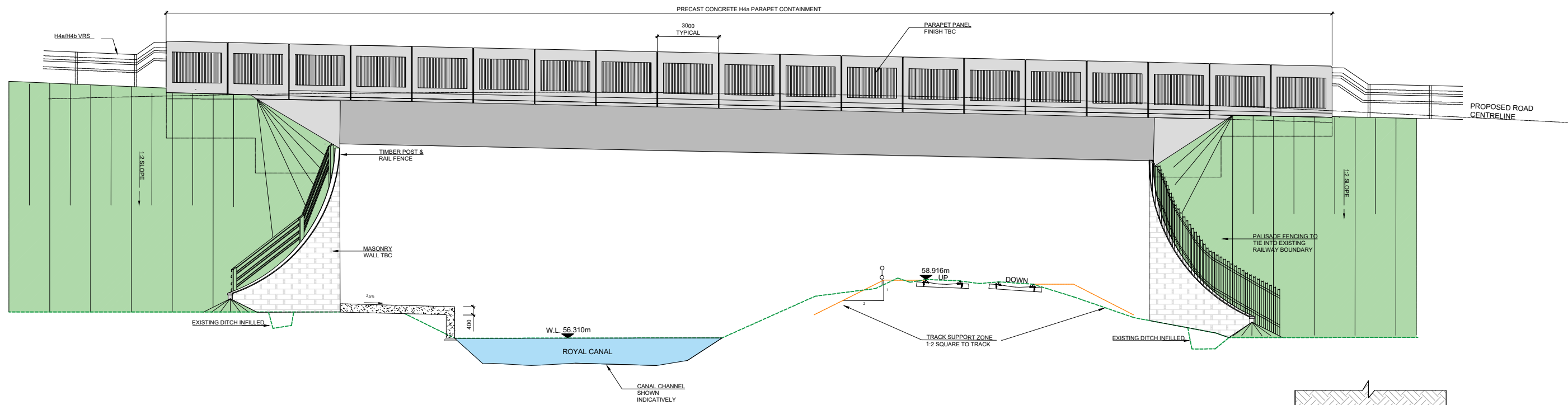

SOUTHERN ELEVATION
SCALE 1:100 A1
SCALE 1:200 A3

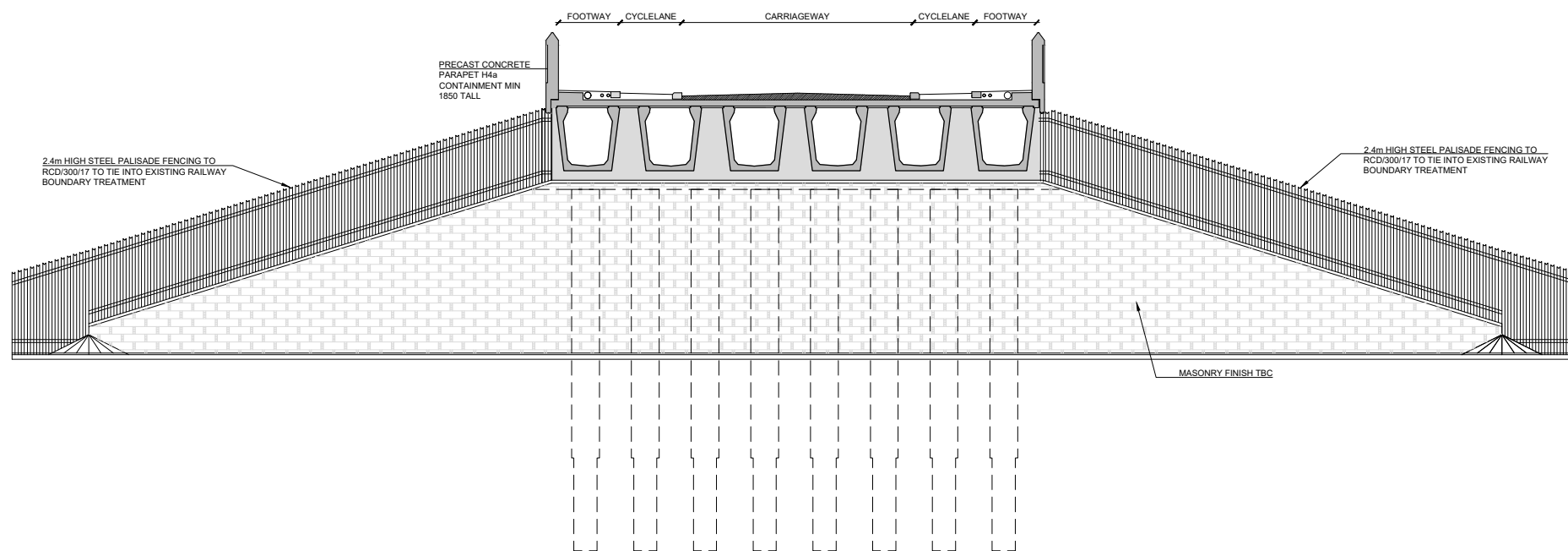

ELEVATION ON REINFORCED EARTH WALL
SCALE 1:100 A1
SCALE 1:200 A3

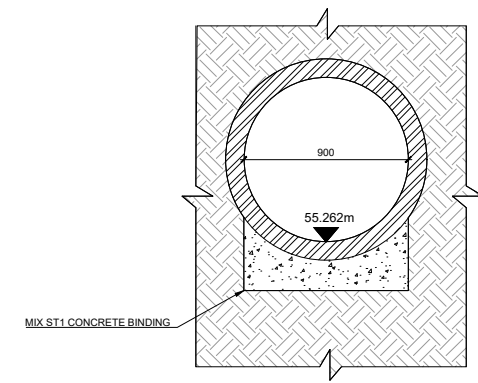

**SECTION D-D
PIPED CULVERT CROSS SECTION**
SCALE 1:20 A1
SCALE 1:40 A3

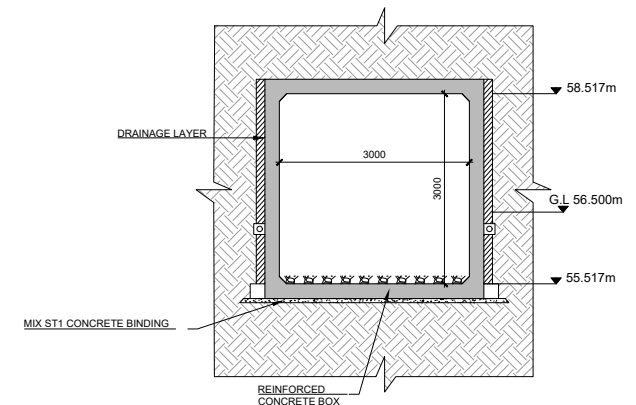

**SECTION C-C
BOX CULVERT CROSS SECTION**
SCALE 1:50 A1
SCALE 1:100 A3

| | | | | | |
|------|------------|----------------|-------------|-------------|-------------|
| REV. | DATE | DESCRIPTION | PRODUCED BY | REVIEWED BY | APPROVED BY |
| V01 | April 2022 | PLANNING ISSUE | IT | PC | MK |

Client

Consultant

Project

Drawing Title

**STRUCTURES DESIGN - LC05: BARBERSTOWN
BRIDGE GENERAL ARRANGEMENT - ELEVATIONS
SHEET 2 OF 3**

Scale: 1:100 @ A1 1:200 @ A3

Drawing Number | Project | Originator | Discipline | Location | Type | Role | Number | Phase
MAY MDC STR LC05 DR C 0202 D

Date: April 2022 Job No: P/101086 Status: F1 - Approved & Accepted Rev: V 01 Sheet: 02 of 03

© Irish Rail (2021). This drawing is confidential and the copyright in it is owned by Irish Rail. This drawing must not be either loaned, copied or otherwise reproduced in whole or in part or used for any purpose without the prior permission of Irish Rail.
© Ordnance Survey Ireland and Government of Ireland. All O.S. data used for plans are printed under "Copyright Ordnance Survey Ireland" Survey No. 0038721 (OSi Aerial Data or OSi Lidar Data) & Survey No. 202105L_NMA_180 (OSi Vector Data).
All elevations are in metres and relate to OSi Geoid Model (OSGMD2) Malin Head as defined by existing Project Control.
All Co-ordinates are in Irish Transverse Mercator Grid (ITM) as defined by OSi active GPS station TaBágh College (TLL0).

NOTES

1. ALL DIMENSIONS ARE IN MILLIMETRES UNLESS NOTED OTHERWISE
2. ALL CHAINAGES ARE IN METRES
3. ALL LEVELS IN METRES ABOVE ORDNANCE DATUM MALIN

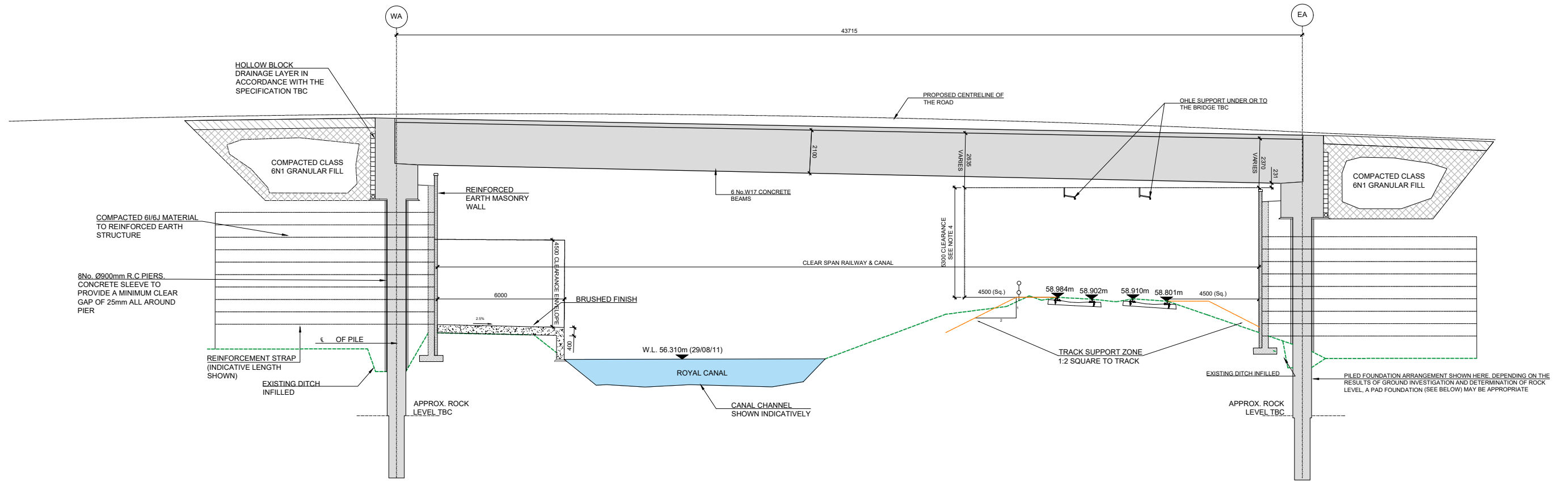

SECTION B-B
SCALE 1:100 A1
SCALE 1:200 A3

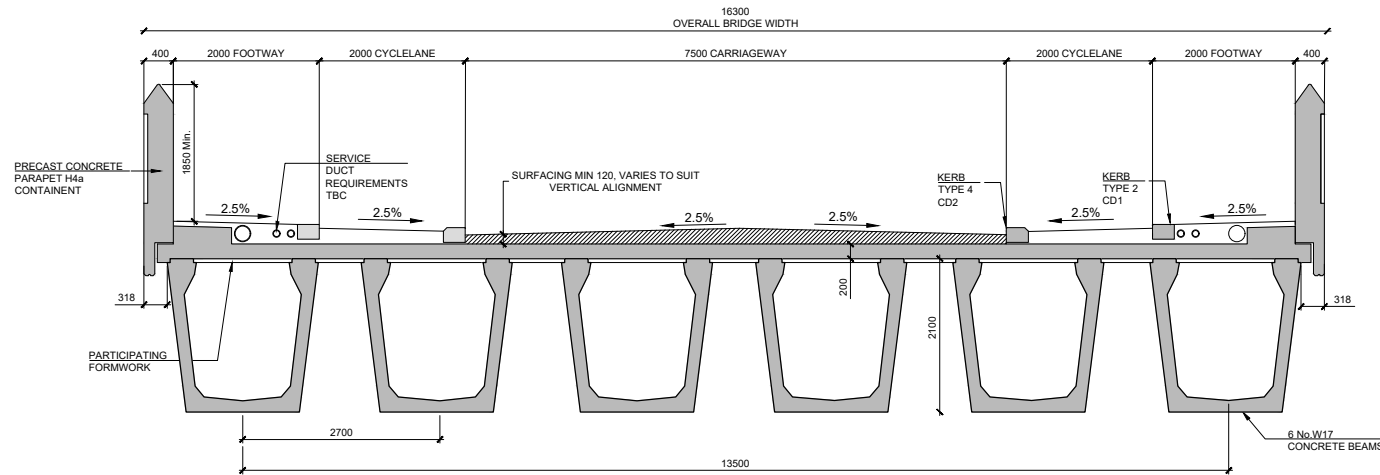

SECTION A-A
SCALE 1:50 A1
SCALE 1:100 A3

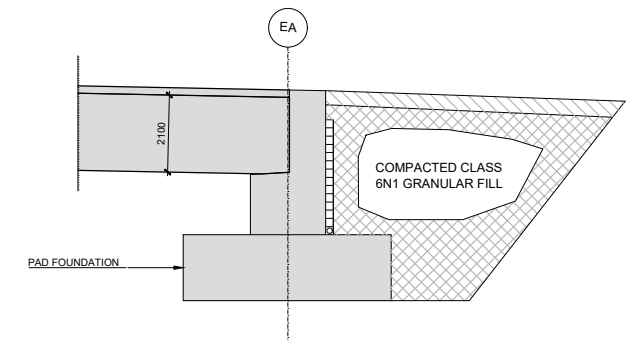

ALTERNATIVE PAD FOUNDATION DETAIL
SCALE 1:100 A1
SCALE 1:200 A3

| | | | | | | | | | |
|------------|---|----------------|----|---|----|-------------|----------------------------|-------------|--|
| Client | Tionascail Éireann Project Ireland 2040 | | | NTA Udarás Náisiúnta Iompartha National Transport Authority | | | Iarnród Éireann Irish Rail | | |
| Consultant | IDOM | | | G3 | | | FIROD | | |
| REV. | DATE | DESCRIPTION | IT | PC | MK | PRODUCED BY | REVIEWED BY | APPROVED BY | |
| V01 | April 2022 | PLANNING ISSUE | | | | | | | |

Client: Tionascail Éireann Project Ireland 2040, NTA Udarás Náisiúnta Iompartha National Transport Authority, Iarnród Éireann Irish Rail

Consultant: IDOM, G3, FIROD

Project: DART+ West

Drawing Title: STRUCTURES DESIGN - LC05: BARBERSTOWN BRIDGE GENERAL ARRANGEMENT - SECTIONS SHEET 3 OF 3

Drawing Number: MAY MDC STR LC05 DR C 0203 D

Date: April 2022 | Job No: P/101086 | Status: F1 - Approved & Accepted | Rev: V 01 | Sheet: 03 of 03

© Irish Rail (2021). This drawing is confidential and the copyright in it is owned by Irish Rail. This drawing must not be either loaned, copied or otherwise reproduced in whole or in part or used for any purpose without the prior permission of Irish Rail.
© Ordnance Survey Ireland and Government of Ireland. All O.S. data used for plans are printed under "Copyright Ordnance Survey Ireland" Survey No. 0038721 (OSi Aerial Data or OSi Lidar Data) & Survey No. 2021051_NMA_180 (OSi Vector Data).
All elevations are in metres and relate to OSi Geoid Model (OSGM02) Malin Head as defined by existing Project Control.
All Co-ordinates are in Irish Transverse Mercator Grid (ITM) as defined by OSi active GPS station Tallaght College (TLTG).

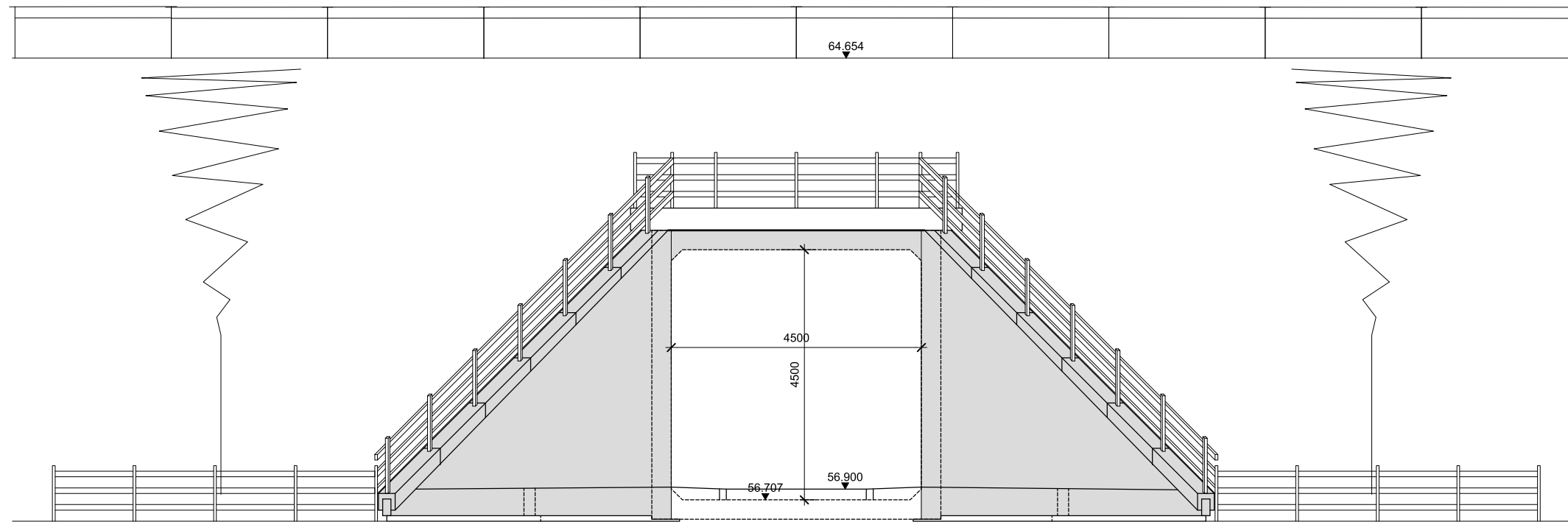
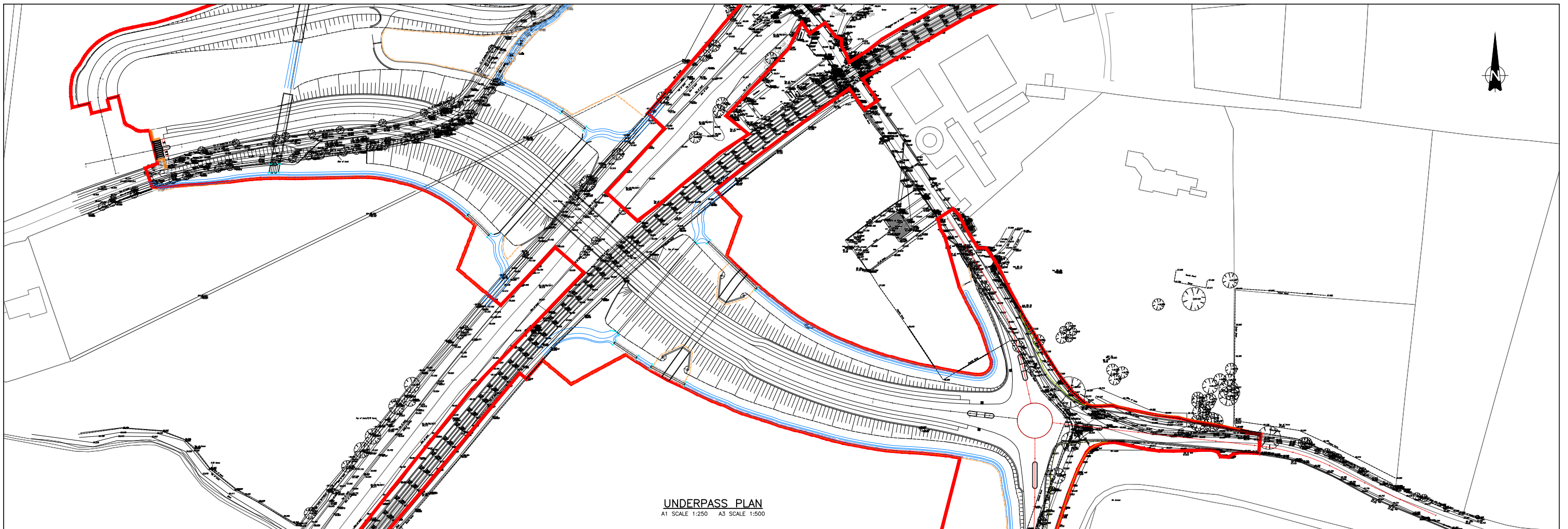

| | | | | | |
|------|----------|-------------|-------------|-------------|-------------|
| REV | DATE | DESCRIPTION | PRODUCED BY | REVIEWED BY | APPROVED BY |
| V 01 | May 2023 | PLANNING | LA | MH | MH |

© Irish Rail (2021). This drawing is confidential and the copyright in it is owned by Irish Rail. This drawing must not be either loaned, copied or otherwise reproduced in whole or in part or used for any purpose without the prior permission of Irish Rail.
© Ordnance Survey Ireland and Government of Ireland. All O.S. data used for plans are printed under "Copyright Ordnance Survey Ireland".
Survey No. 9039721 (OSI Aerial Data or OSI Lidar Data) & Survey No. 2021051_NMA_180 (OSI Vector Data).
All elevations are in metres and relate to OSI Geoid Model (OSGM02) Mean-Higher as defined by existing Project Control.
All Coordinates are in Irish Transverse Mercator Grid (ITM) as defined by OSI active GPS station Tallaght College (TLL0).

Client

Tionscaldal Éireann
Project Ireland 2040

NTA
Údairis Náisiúnta Iompartha
National Transport Authority

Iarnród Éireann
Irish Rail

Consultant

IDOM

G3

IRIOD
ROGHIAN & O'DONOVAN

Project

DART+
West

Drawing Title

STRUCTURES DESIGN - LC05: BARBERSTOWN
LANDOWNER UNDERPASS
SHEET 1 OF 1

Scale:
AS SHOWN

Drawing Number | Project | Originator | Discipline | Location | Type | Role | Number | Phase

MAY MDC STR LC05 DR C 0205 D

Date: September 2023 Job No: P/101086 Status: F1 - Approved & Accepted Rev: V 01 Sheet: 01 of 01