

--- EXISTING ROAD LEVEL

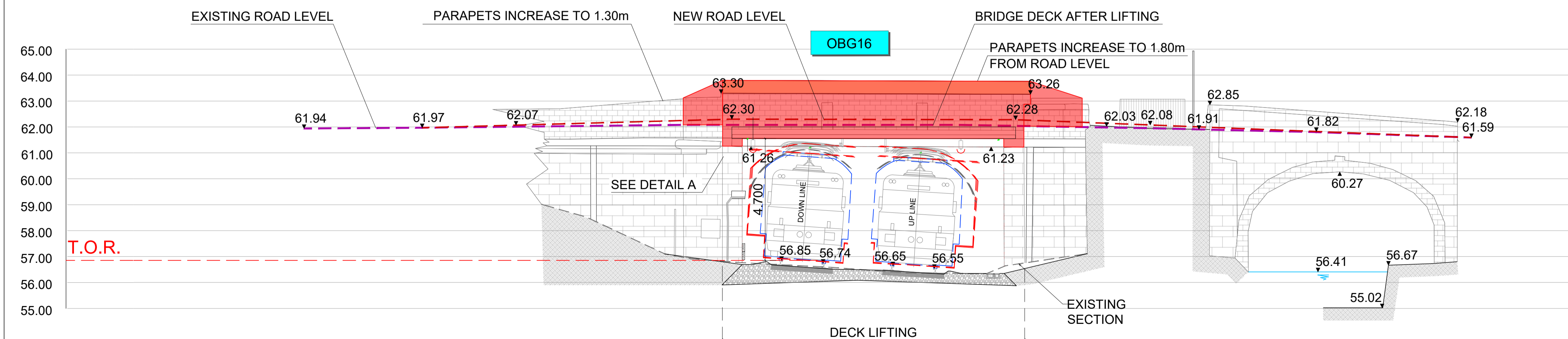

--- NEW ROAD LEVEL (THE PROPOSED ROAD ALIGNMENT TO BE UPDATED)

■ BRIDGE LIFTING 290 mm  
--- ROAD LEVEL LIFTING (THE PROPOSED ROAD ALIGNMENT TO BE UPDATED) TO REACH 4.4 m CONTACT WIRE HEIGHT BRINGING THE MESSENGER WIRE TO THE CONTACT WIRE LEVEL

V01	May 2021	PUBLIC CONSULTATION	JBB	ACJ	CCH
REV.	DATE	DESCRIPTION	PRODUCED BY	REVIEWED BY	APPROVED BY

© Irish Rail (2020). This drawing is confidential and the copyright in it is owned by Irish Rail. This drawing must not be either loaned, copied or otherwise reproduced in whole or in part or used for any purpose without the prior permission of Irish Rail.  
 © Ordnance Survey Ireland and Government of Ireland. All O.S. data used for plans are printed under "Copyright Ordnance Survey Ireland" Survey No. 6039720 (OSi Aerial Data or OSi Lidar Data) & Survey No. 2020OSI\_NMA\_180 (OSi Vector Data).  
 All elevations are in metres and relate to OSi Geoid Model (OBGM02) Malin Head as defined by existing Project Control.  
 All Co-ordinates are in Irish Transverse Mercator Grid (ITM) as defined by OSi active GPS station Tallaght College (TLG).

Client

Consultant

Project

Drawing Title

STRUCTURE  
OBG16. BRIDGE DECK HEAVY LIFTING

Scale: 1:100 @ A1

Drawing Number | Project | Originator | Discipline | Location | Type | Role | Number | Phase  
MAY MDC STR RS13 DR C 0001 B

Date: May 2021 | Job No: P/101086 | Status: S4 Acceptance | Rev: V01 | Sheet: 1 of 4



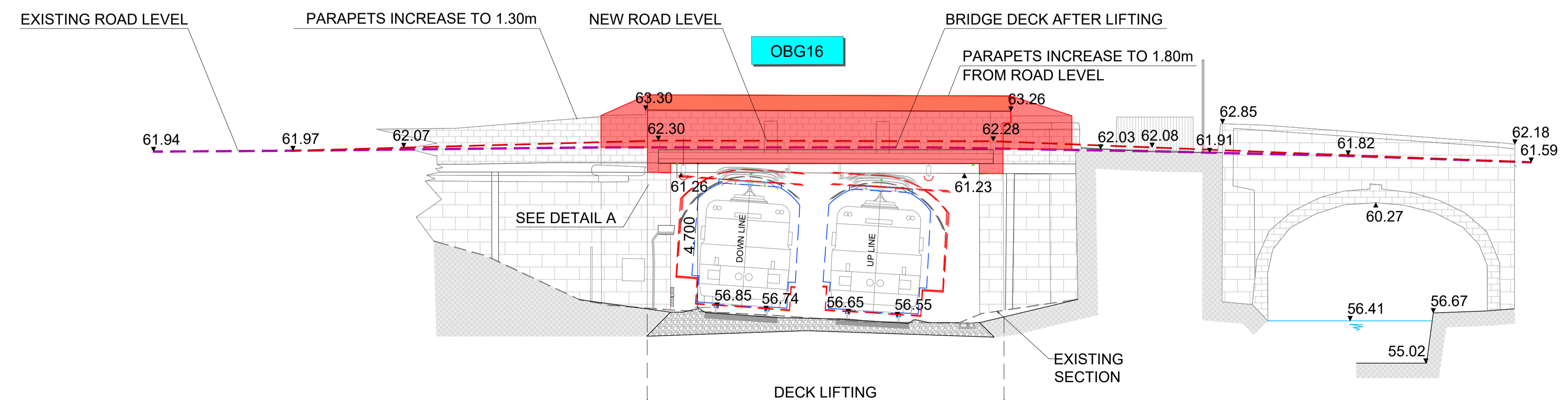
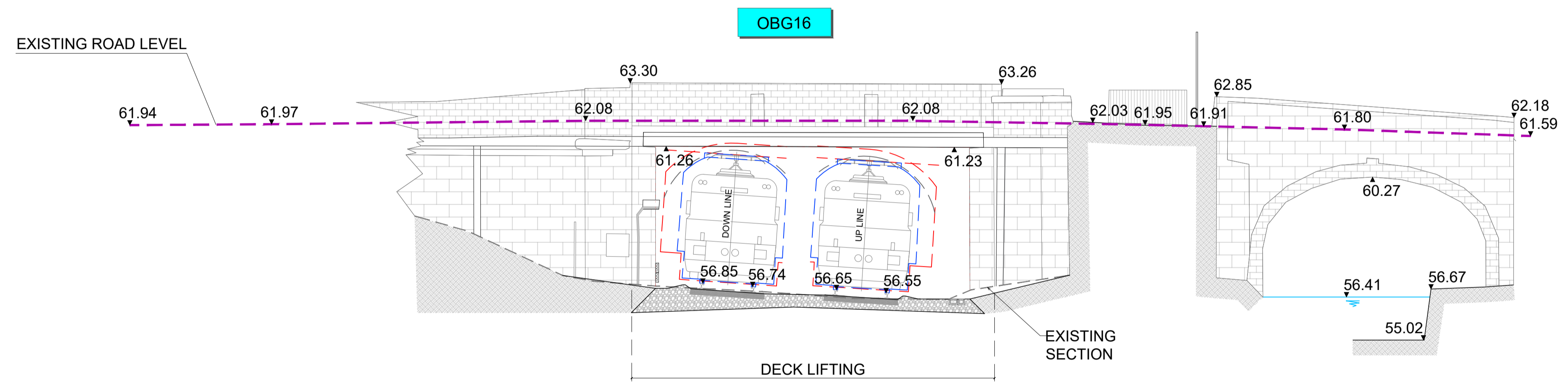
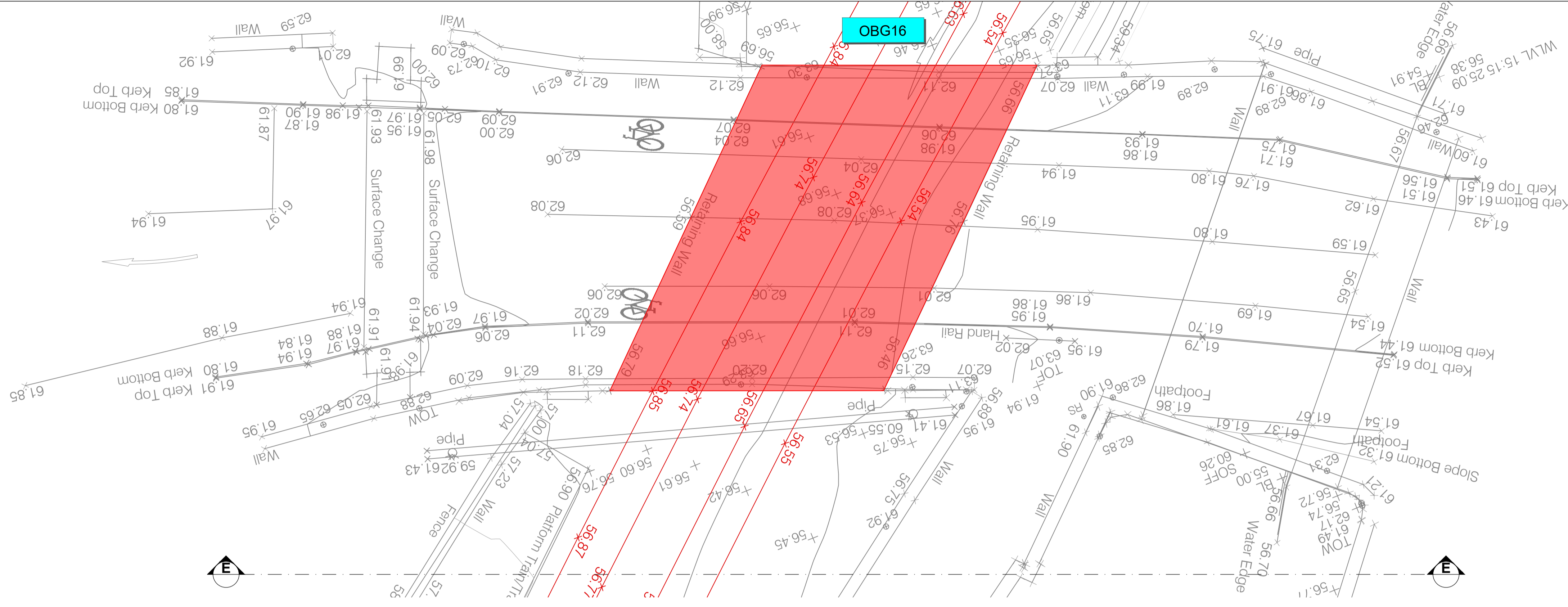
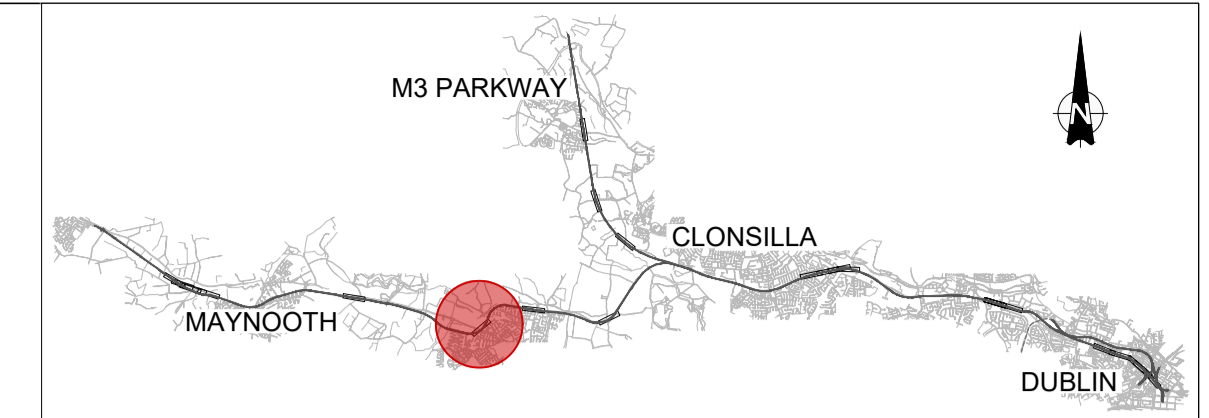

█ BRIDGE LIFTING 290 mm  
- - - ROAD LEVEL LIFTING (THE PROPOSED ROAD ALIGNMENT TO BE UPDATED) TO REACH 4.4 m CONTACT WIRE HEIGHT BRINGING THE MESSENGER WIRE TO THE CONTACT WIRE LEVEL

REV	DATE	DESCRIPTION	PRODUCED BY	REVIEWED BY	APPROVED BY
V01	May 2021	PUBLIC CONSULTATION	JBB	ACJ	CCH

© Irish Rail (2020). This drawing is confidential and the copyright in it is owned by Irish Rail. This drawing must not be either loaned, copied or otherwise reproduced in whole or in part or used for any purpose without the prior permission of Irish Rail.  
 © Ordnance Survey Ireland and Government of Ireland. All O.S. data used for plans are printed under "Copyright Ordnance Survey Ireland".  
 Survey No. 6039720 (OSi Aerial Data or OSi Lidar Data) & Survey No. 2020/OSI\_NMA\_180 (OSi Vector Data).  
 All elevations are in metres and relate to OSi Geoid Model (OBGM02) Malin Head as defined by existing Project Control.  
 All Co-ordinates are in Irish Transverse Mercator Grid (ITM) as defined by OSi active GPS station Tallaght College (TLG0).

Client

Consultant

Project

Drawing Title

**STRUCTURE**  
OBG16. BRIDGE DECK HEAVY LIFTING

Scale: 1:100 @ A1

Drawing Number | Project | Originator | Discipline | Location | Type | Role | Number | Phase  
 MAY MDC STR RS13 DR C 0001 B

Date: May 2021 | Job No: P/101086 | Status: S4 Acceptance | Rev: V01 | Sheet: 2 of 4



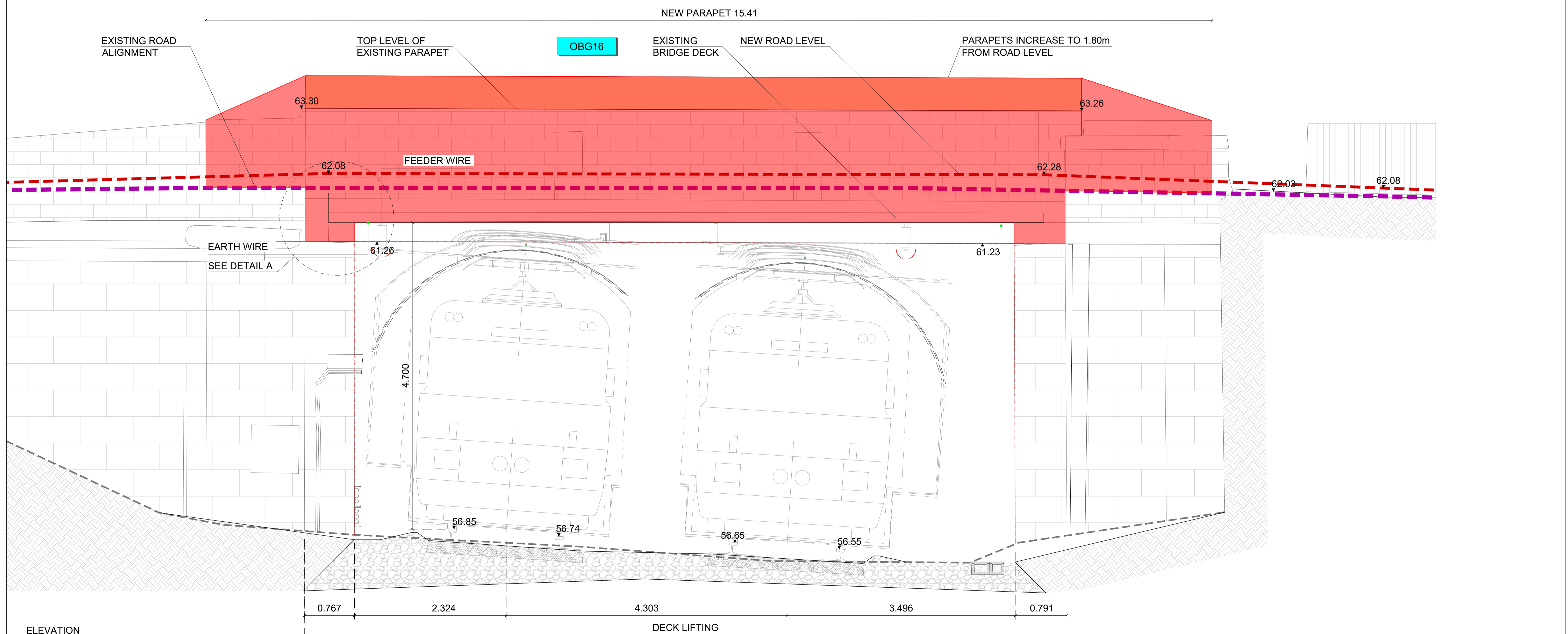
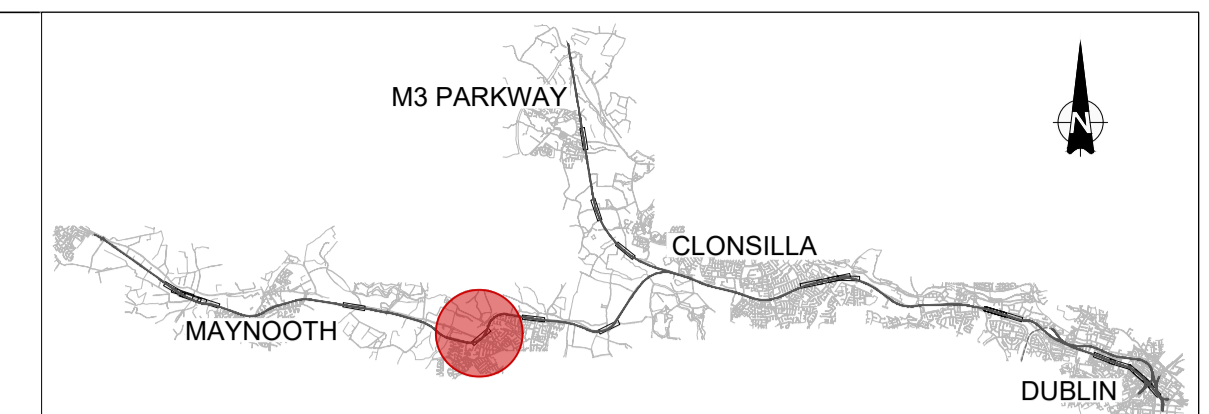
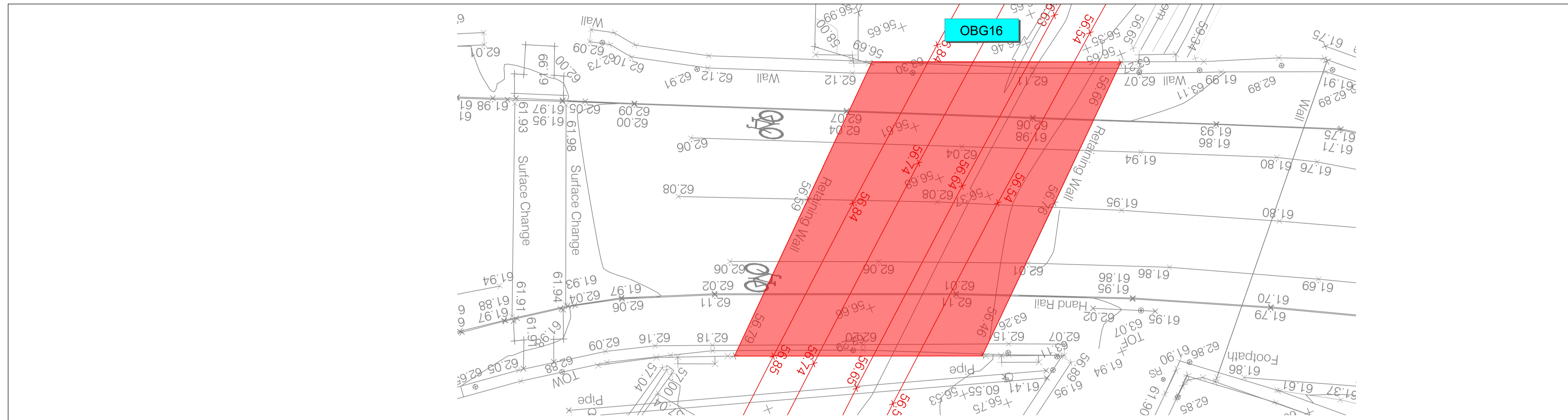

ELEVATION SCALE: 1:30

REV	DATE	DESCRIPTION	PRODUCED BY	REVIEWED BY	APPROVED BY
V01	May 2021	PUBLIC CONSULTATION	JBB	ACJ	CCH

© Irish Rail (2020). This drawing is confidential and the copyright in it is owned by Irish Rail. This drawing must not be either loaned, copied or otherwise reproduced in whole or in part or used for any purpose without the prior permission of Irish Rail.  
 © Ordnance Survey Ireland and Government of Ireland. All O.S. data used for plans are printed under "Copyright Ordnance Survey Ireland".  
 Survey No. 0039720 (OSi Aerial Data or OSi Lidar Data) & Survey No. 2020OSI\_NMA\_180 (OSi Vector Data).  
 All elevations are in metres and relate to OSi Geoid Model (OBGM02) Mean Head as defined by existing Project Control.  
 All Co-ordinates are in Irish Transverse Mercator Grid (ITM) as defined by OSi active GPS station Tallaght College (TLLG).

Client

Consultant

Project

Drawing Title

STRUCTURE  
OBG16. BRIDGE DECK HEAVY LIFTING

Scale: 1:100 @ A1

Drawing Number	Project	Originator	Discipline	Location	Type	Role	Number	Phase
	MAY	MDC	STR	RS13	DR	C	0001	B

Date:	Job No:	Status:	Rev:	Sheet:
May 2021	P/101086	S4 Acceptance	V01	3 of 4



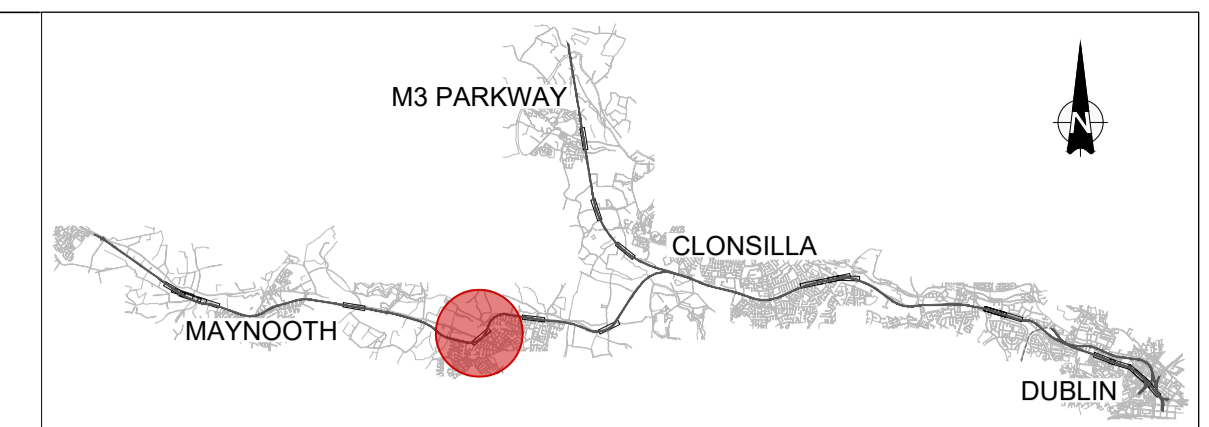
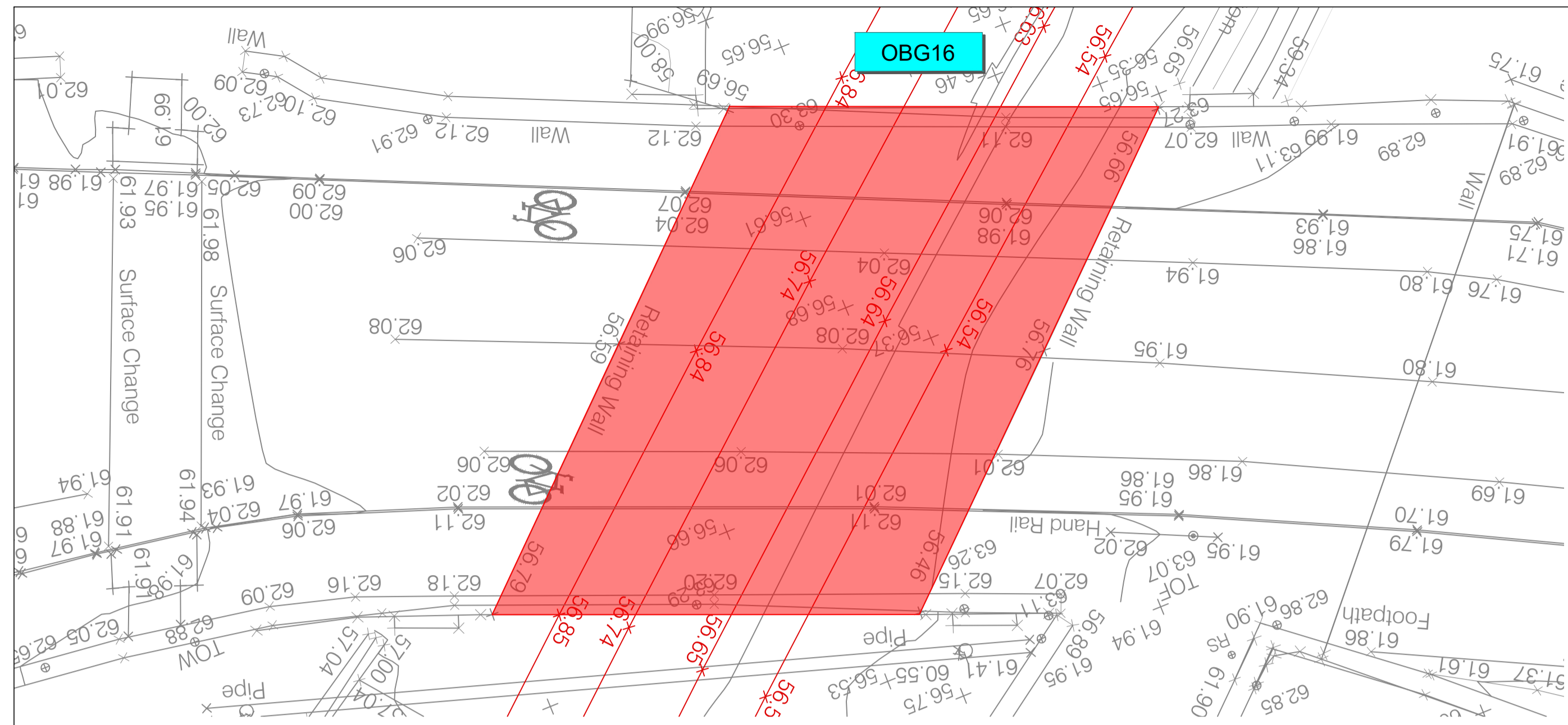

- CONSTRUCTION PHASE:**
- 1 - PLACE TEMPORARY STEEL FRAME TIGHT AGAINST THE ABUTMENTS TO SUPPORT THE BRIDGE DECK
  - 2 - REMOVE THE EXISTING PAVEMENT TO REDUCE DEAD LOAD
  - 3 - EXCAVATE TO THE ABUTMENT LEVEL
  - 4 - VERTICAL CUT IN THE EDGES OF THE STRUCTURAL DECK AND HORIZONTAL CUT BETWEEN THE ABUTMENTS AND THE DECK
  - 5 - INSERT JACKS AND JACK UP THE DECK
  - 6 - DEMOLISH THE TOP PART OF THE ABUTMENT TO REACH THE EXISTING REINFORCEMENT
  - 7 - NEWLY HEIGHTENED DECK SUPPORT SECTION MUST BE CONNECTED WITH STEEL BARS AND CONNECTED TO THE EXISTING STEEL REINFORCEMENT, AND CONCRETE SHOULD BE POURED TO THE NEW ELEVATION
  - 8 - FINALLY, RECONSTRUCT THE CONNECTION BETWEEN THE DECK AND THE ABUTMENT

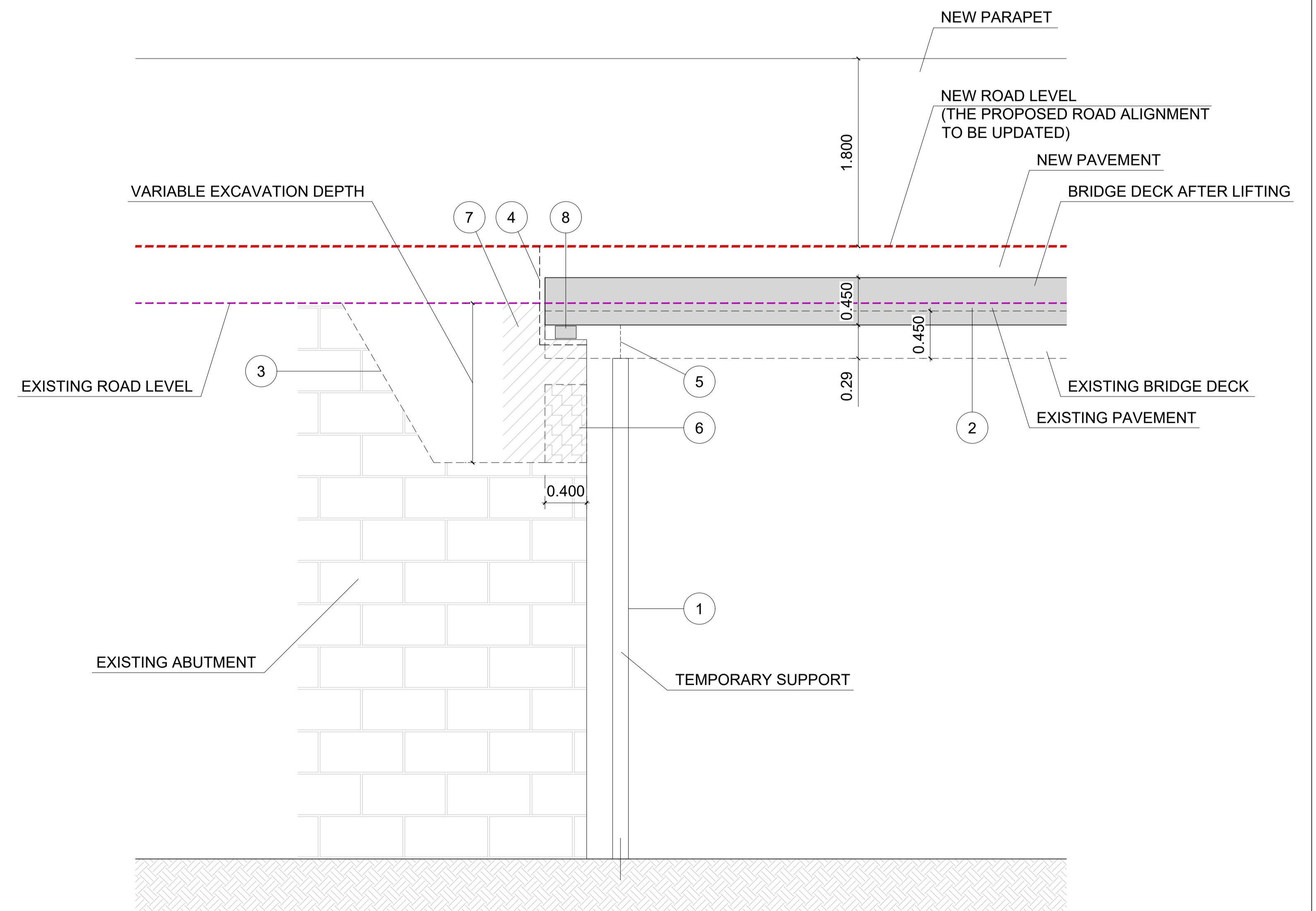
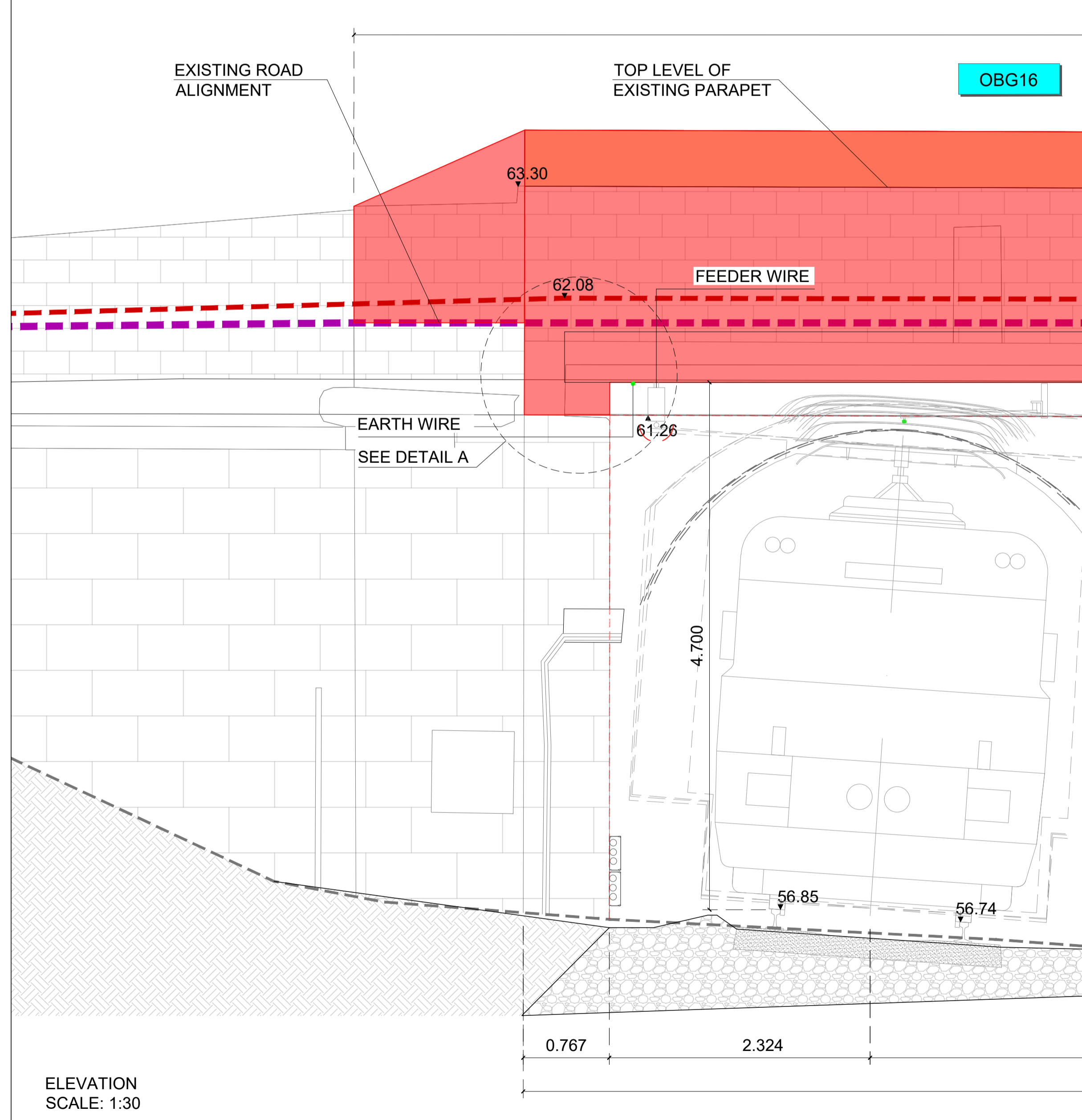

ELEVATION  
SCALE: 1:30

DETAIL A  
SCALE: 1:30

REV	DATE	DESCRIPTION	JBB	ACJ	CCH
V01	May 2021	PUBLIC CONSULTATION			

© Irish Rail (2020). This drawing is confidential and the copyright in it is owned by Irish Rail. This drawing must not be either loaned, copied or otherwise reproduced in whole or in part or used for any purpose without the prior permission of Irish Rail.  
 © Ordnance Survey Ireland and Government of Ireland. All O.S. data used for plans are printed under "Copyright Ordnance Survey Ireland".  
 Survey No. 0039720 (OSi Aerial Data or OSi Lidar Data) & Survey No. 2020OSI\_NMA\_180 (OSi Vector Data).  
 All elevations are in metres and relate to OSi Geoid Model (OSGM02) Malin Head as defined by existing Project Control.  
 All Co-ordinates are in Irish Transverse Mercator Grid (ITM) as defined by OSi active GPS station Tallaght College (TLG).

Client

Tionscadal Éireann Project Ireland 2040

NTA Udarás Náisiúnta Iompará Náisiúnta Transport Authority

Iarnród Éireann Irish Rail

Consultant

IDOM

PRO3

FIROD ROUGHAN & O'DONOVAN

Project

DART+ West

Drawing Title

STRUCTURE  
OBG16. BRIDGE DECK HEAVY LIFTING

Scale: 1:100 @ A1

Drawing Number | Project | Originator | Discipline | Location | Type | Role | Number | Phase  
MAY MDC STR RS13 DR C 0001 B

Date: May 2021 | Job No: P/101086 | Status: S4 Acceptance | Rev: V01 | Sheet: 4 of 4