

SITE PLAN

REV.	DATE	DESCRIPTION	BAC	CCH	TMK
V 01	May 2021	PUBLIC CONSULTATION			

© Irish Rail (2021). This drawing is confidential and the copyright in it is owned by Irish Rail. This drawing must not be either loaned, copied or otherwise reproduced in whole or in part or used for any purpose without the prior permission of Irish Rail.
 © Ordnance Survey Ireland and Government of Ireland. All O.S. data used for plans are printed under "Copyright Ordnance Survey Ireland".
 Survey No. 6039720 (OSi Aerial Data or OSi Lidar Data) & Survey No. 2021051_NMA_180 (OSi Vector Data).
 All elevations are in metres and relate to OSi Geoid Model (OSGM02) Malin Head as defined by existing Project Control.
 All Co-ordinates are in Irish Transverse Mercator Grid (ITM) as defined by OSi active GPS station Tallaght College (TLG0).

Client

Tionscatal Éireann
Project Ireland
2040

NTA
Údarás Náisiúnta Iompair
National Transport Authority

Irish Rail

Consultant

IDOM

G3

IROD
ROUGHAN & O'DONOVAN

Project

DART+
West

Drawing Title

CONNOLLY STATION.
GENERAL LAYOUT - SITE PLAN, FLOOR PLANS AND SECTIONS
SITE PLAN

Scale:
1: 500 @ A1

Drawing Number | Project | Originator | Discipline | Location | Type | Role | Number | Phase
MAY MDC ARC RS02 DR A 0001 B

Date: May 2021 | Job No: P/101086 | Status: S4 Suitable for Acceptance | Rev: V 01 | Sheet: 1 of 4



REV.	DATE	DESCRIPTION	BAC	CCH	TMK
V 01	May 2021	PUBLIC CONSULTATION			

© Irish Rail (2021). This drawing is confidential and the copyright in it is owned by Irish Rail. This drawing must not be either loaned, copied or otherwise reproduced in whole or in part or used for any purpose without the prior permission of Irish Rail.
 © Ordnance Survey Ireland and Government of Ireland. All O.S. data used for plans are printed under "Copyright Ordnance Survey Ireland".
 Survey No. 6039720 (OSI Aerial Data or OSI Lidar Data) & Survey No. 2021051_NMA_180 (OSI Vector Data).
 All elevations are in metres and relate to OSI Geoid Model (OSGM02) Mean Head as defined by existing Project Control.
 All Co-ordinates are in Irish Transverse Mercator Grid (ITM) as defined by OSI active GPS station Tallaght College (TLG9).

Client

Tionscatal Éireann
Project Ireland
2040

NTA
Údarás Náisiúnta Iompar
National Transport Authority

Iarnród Éireann
Irish Rail

Consultant

IDOM

G3

PROD

ROUGHAN & O'DONOVAN

Project

DART+
West

Drawing Title

CONNOLLY STATION.
GENERAL LAYOUT - SITE PLAN, FLOOR PLANS AND SECTIONS
STREET LEVEL

Scale:
1:200 @ A1

Drawing Number | Project | Originator | Discipline | Location | Type | Role | Number | Phase
MAY MDC ARC RS02 DR A 0001 B

Date: May 2021 | Job No: P/101086 | Status: S4 Suitable for Acceptance | Rev: V 01 | Sheet: 3 of 4

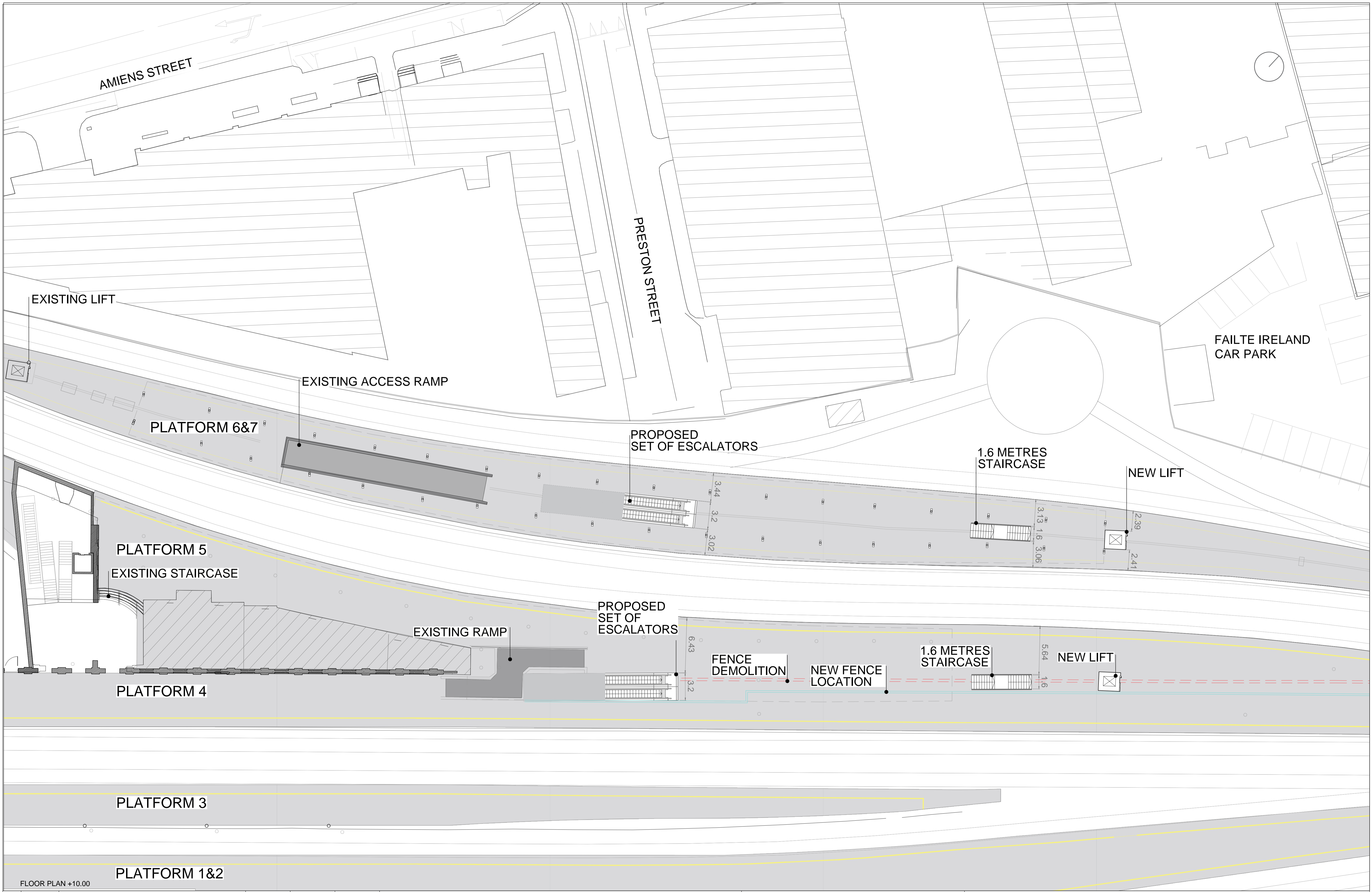

REV.	DATE	DESCRIPTION	BAC	CCH	TMK
V 01	May 2021	PUBLIC CONSULTATION			

© Irish Rail (2021). This drawing is confidential and the copyright in it is owned by Irish Rail. This drawing must not be either loaned, copied or otherwise reproduced in whole or in part or used for any purpose without the prior permission of Irish Rail.
 © Ordnance Survey Ireland and Government of Ireland. All O.S. data used for plans are printed under "Copyright Ordnance Survey Ireland".
 Survey No. 6039720 (OSi Aerial Data or OSi Lidar Data) & Survey No. 2021OSI_NMA_180 (OSi Vector Data).
 All elevations are in metres and relate to OSi Geoid Model (OSGM02) Malin Head as defined by existing Project Control.
 All Co-ordinates are in Irish Transverse Mercator Grid (ITM) as defined by OSi active GPS station Tallaght College (TLG9).

Client

Tionscadal Éireann Project Ireland 2040

NTA Údarás Náisiúnta Iompar National Transport Authority

lanróid Éireann Irish Rail

Consultant

IDOM

G3

IROD ROUGHAN & O'DONOVAN

Project

DART+ West

Drawing Title

CONNOLLY STATION.
GENERAL LAYOUT - SITE PLAN, FLOOR PLANS AND SECTIONS
PLATFORM LEVEL

Scale: 1:200 @ A1

Drawing Number | Project | Originator | Discipline | Location | Type | Role | Number | Phase
MAY MDC ARC RS02 DR A 0001 B

Date: May 2021 | Job No: P/101086 | Status: S4 Suitable for Acceptance | Rev: V 01 | Sheet: 2 of 4

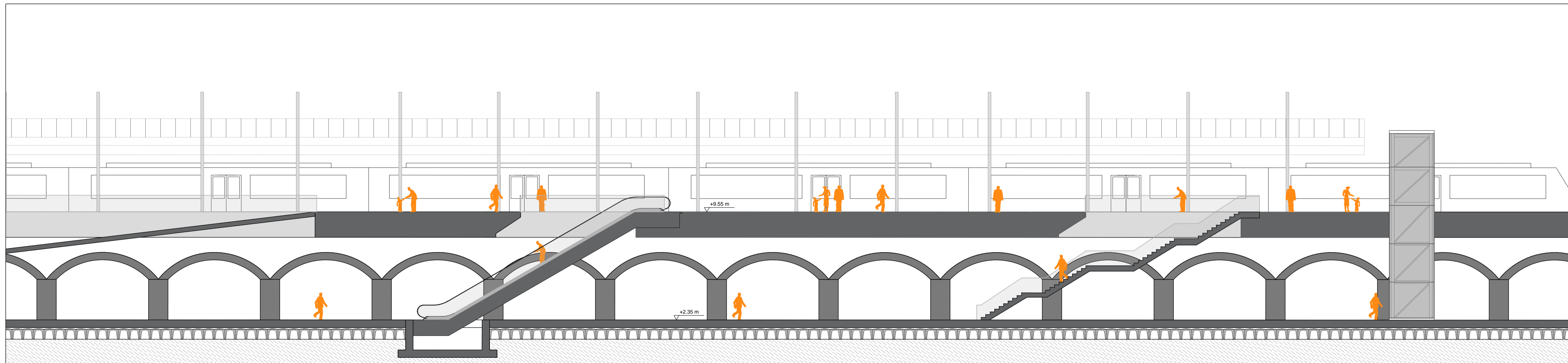

SECTION 1

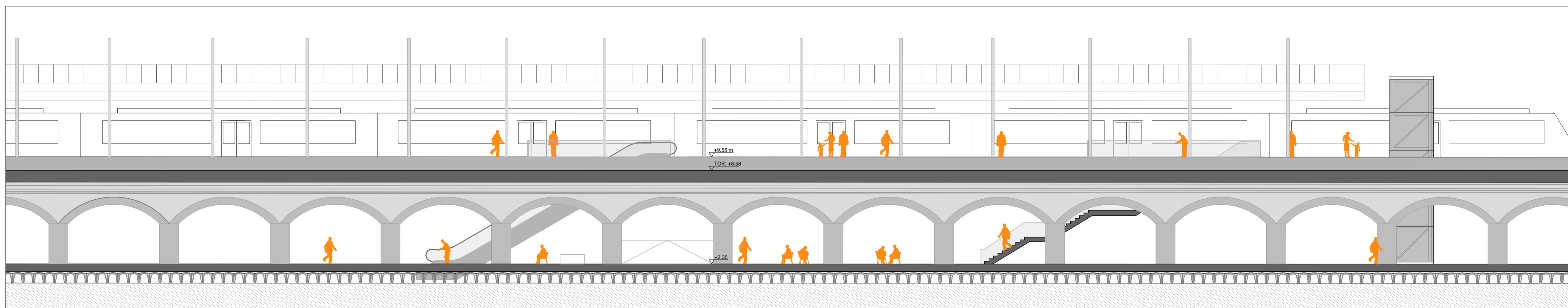

SECTION 2

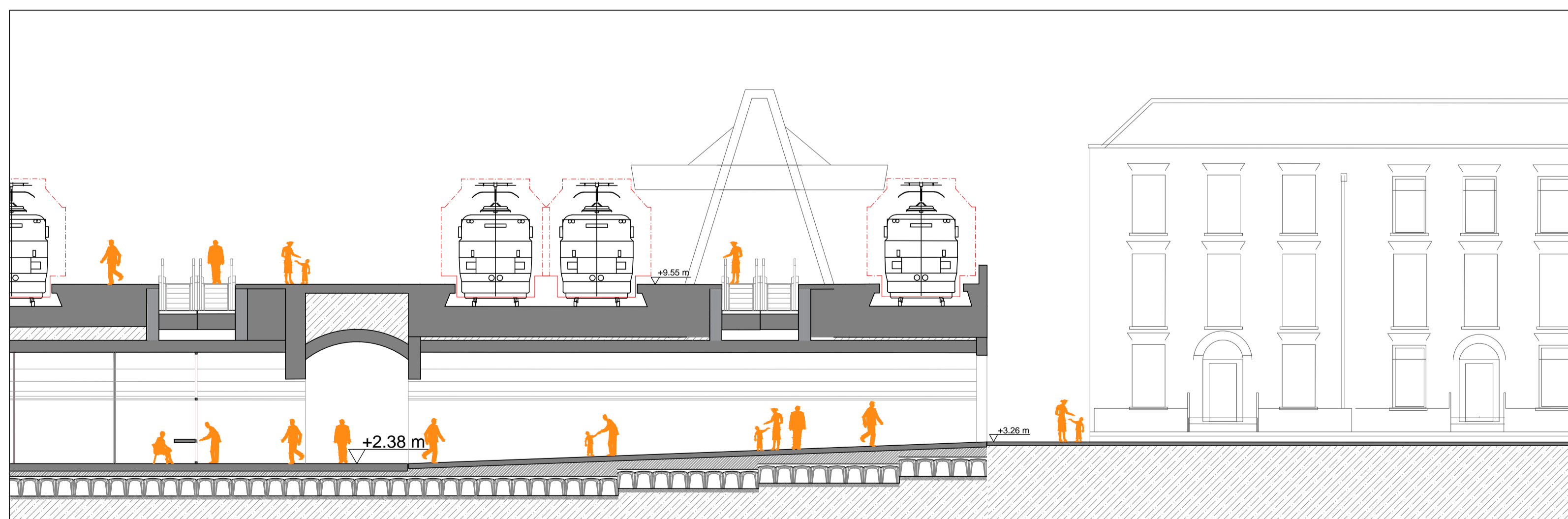

SECTION 3

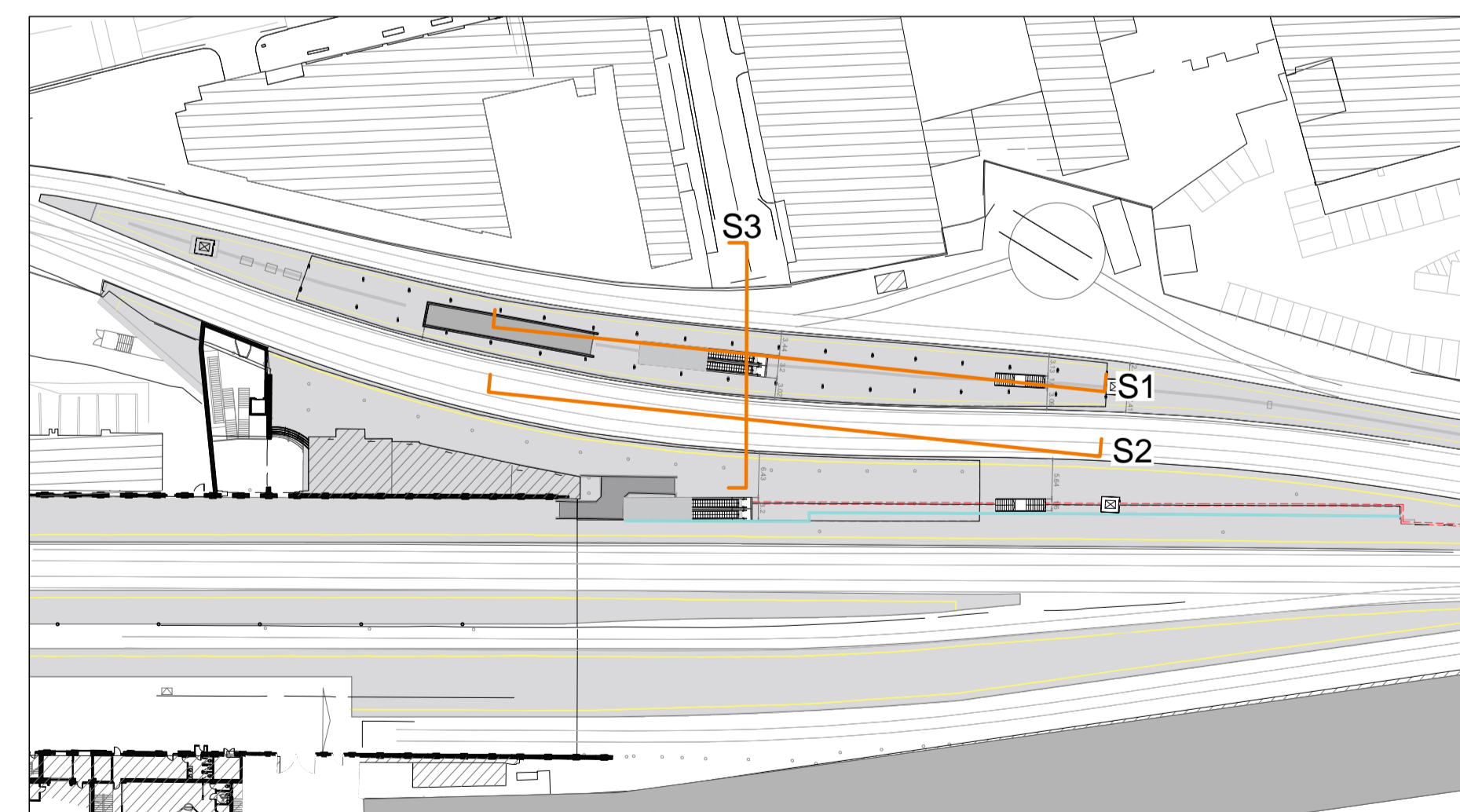

REV.	DATE	DESCRIPTION	BAC	CCH	TMK
V 01	May 2021	PUBLIC CONSULTATION			
<small>© Irish Rail (2021). This drawing is confidential and the copyright in it is owned by Irish Rail. This drawing must not be either loaned, copied or otherwise reproduced in whole or in part or used for any purpose without the prior permission of Irish Rail. © Ordnance Survey Ireland and Government of Ireland. All O.S. data used for plans are printed under "Copyright Ordnance Survey Ireland". Survey No. 6039720 (OSI Aerial Data or OSi Lidar Data) & Survey No. 2021051_NMA_190 (OSi Vector Data). All elevations are in metres and relate to OSi Geoid Model (OSGM02) Malin Head as defined by existing Project Control. All Co-ordinates are in Irish Transverse Mercator Grid (ITM) as defined by OSi active GPS station Tallaght College (TLG9).</small>					

Client

Tionscadal Éireann Project Ireland 2040

NTA Údarás Náisiúnta Iompair National Transport Authority

lanróid Éireann Irish Rail

Consultant

IDOM

G3

PROJ ROD ROUGHAN & O'DONOVAN

Project

DART+ West

Drawing Title

CONNOLLY STATION.
GENERAL LAYOUT - SITE PLAN, FLOOR PLANS AND SECTIONS
SECTIONS

Scale: 1:150 @ A1

Drawing Number | Project | Originator | Discipline | Location | Type | Role | Number | Phase
MAY MDC ARC RS02 DR A 0001 B

Date: May 2021 | Job No: P/101086 | Status: S4 Suitable for Acceptance | Rev: V 01 | Sheet: 4 of 4